

FAG

★ HS7007-E-T-P4S-UL

Angular contact ball bearing

Schaeffler ID:
0380447060000

★ Preferred product

Spindle bearings HS70...-E, adjusted,
in pairs or sets, contact angle $\alpha = 25^\circ$,
restricted tolerances

Technical information

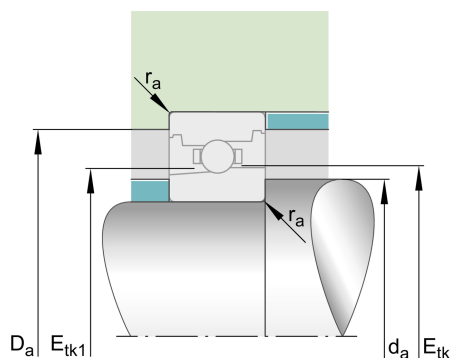
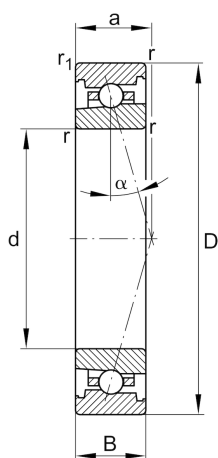

Temperature range

T_{\min}	-30 °C	Operating temperature min.
T_{\max}	100 °C	Operating temperature max.
	0,156 kg	Weight

Main Dimensions & Performance Data

d	35 mm	Bore diameter
D	62 mm	Outside diameter
B	14 mm	Width
C_r	8.400 N	Basic dynamic load rating, radial
C_{0r}	4.700 N	Basic static load rating, radial
C_{ur}	500 N	Fatigue load limit, radial
$n_{G \text{ Grease}}$	30.000 1/min	Limiting speed for grease lubrication
$n_{G \text{ Oil}}$	45.000 1/min	Limiting speed for oil lubrication

Dimensions

r_{\min}	1 mm	Minimum chamfer dimension
$r_{1 \min}$	1 mm	Minimum chamfer dimension
α	25 °	Contact angle

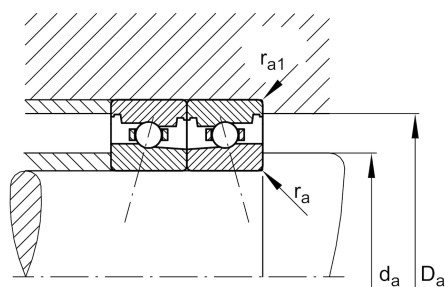

Mounting dimensions

d_a	41 mm	Diameter shaft shoulder
d_a	h12	Diameter shaft shoulder clearance
D_a	56 mm	Shoulder diameter outer ring
D_a	H12	Shoulder diameter outer ring clearance
$r_{a \max}$	1 mm	Maximum recess radius
$r_{a1 \max}$	0,3 mm	Maximum recess radius
$E_{tk \min}$	45,7 mm	Minimum diameter injection pitch
$E_{tk \max}$	46,8 mm	Maximum diameter injection pitch
$E_{tk1 \min}$	43,9 mm	Minimum diameter injection pitch
$E_{tk1 \max}$	46,8 mm	Maximum diameter injection pitch
a	18,3 mm	Distance between the apexes of the pressure cones

Additional information

F_{VL}	51 N	Preload force light
F_{VM}	152 N	Preload force medium
F_{VH}	304 N	Preload force heavy
K_{aEL}	146 N	Lift-off force light
K_{aEM}	448 N	Lift-off force medium
K_{aEH}	915 N	Lift-off force heavy
c_{aL}	67,7 N/ μm	Axial rigidity light
c_{aM}	101 N/ μm	Axial rigidity medium
c_{aH}	132 N/ μm	Axial rigidity heavy