

FAG

HS7008-E-T-P4S-UL

Angular contact ball bearing

Schaeffler ID:
0191841230000Spindle bearings HS70..-E, adjusted,
in pairs or sets, contact angle $\alpha = 25^\circ$,
restricted tolerances

Technical information

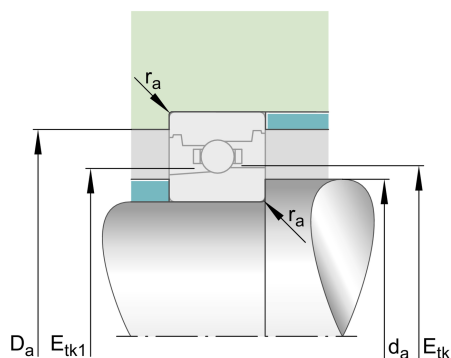
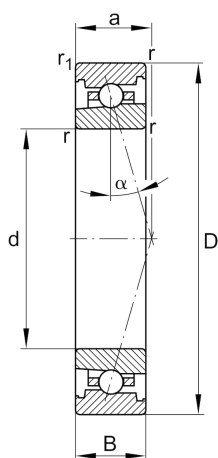
**Temperature range**

| | | |
|-----------|----------|----------------------------|
| T_{min} | -30 °C | Operating temperature min. |
| T_{max} | 100 °C | Operating temperature max. |
| | 0,204 kg | Weight |

Main Dimensions & Performance Data

| | | |
|----------------|--------------|---------------------------------------|
| d | 40 mm | Bore diameter |
| D | 68 mm | Outside diameter |
| B | 15 mm | Width |
| C_r | 8.900 N | Basic dynamic load rating, radial |
| C_{0r} | 5.400 N | Basic static load rating, radial |
| C_{ur} | 570 N | Fatigue load limit, radial |
| $n_{G Grease}$ | 26.000 1/min | Limiting speed for grease lubrication |
| $n_{G Oil}$ | 40.000 1/min | Limiting speed for oil lubrication |

Dimensions

| | | |
|-------------|------|---------------------------|
| r_{min} | 1 mm | Minimum chamfer dimension |
| $r_{1 min}$ | 1 mm | Minimum chamfer dimension |
| α | 25 ° | Contact angle |

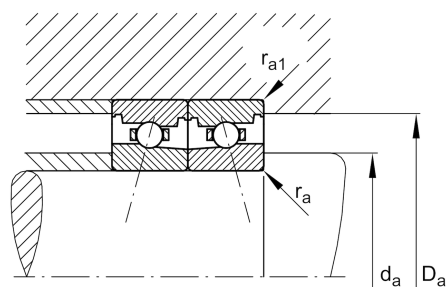

Mounting dimensions

| | | |
|----------------|---------|---|
| d_a | 46 mm | Diameter shaft shoulder |
| d_a | h12 | Diameter shaft shoulder clearance |
| D_a | 62 mm | Shoulder diameter outer ring |
| D_a | H12 | Shoulder diameter outer ring clearance |
| $r_{a \max}$ | 1 mm | Maximum recess radius |
| $r_{a1 \max}$ | 0,3 mm | Maximum recess radius |
| $E_{tk \min}$ | 51,2 mm | Minimum diameter injection pitch |
| $E_{tk \max}$ | 52,3 mm | Maximum diameter injection pitch |
| $E_{tk1 \min}$ | 49,4 mm | Minimum diameter injection pitch |
| $E_{tk1 \max}$ | 52,3 mm | Maximum diameter injection pitch |
| a | 20,1 mm | Distance between the apexes of the pressure cones |

Additional information

| | | |
|-----------|-----------------------|-----------------------|
| F_{VL} | 53 N | Preload force light |
| F_{VM} | 160 N | Preload force medium |
| F_{VH} | 321 N | Preload force heavy |
| K_{aEL} | 154 N | Lift-off force light |
| K_{aEM} | 472 N | Lift-off force medium |
| K_{aEH} | 964 N | Lift-off force heavy |
| c_{aL} | 74,7 N/ μm | Axial rigidity light |
| c_{aM} | 111 N/ μm | Axial rigidity medium |
| c_{aH} | 145 N/ μm | Axial rigidity heavy |