

FAG

HS7009-E-T-P4S-UL

Angular contact ball bearing

Schaeffler ID:
0384688080000Spindle bearings HS70..-E, adjusted,
in pairs or sets, contact angle $\alpha = 25^\circ$,
restricted tolerances

Technical information

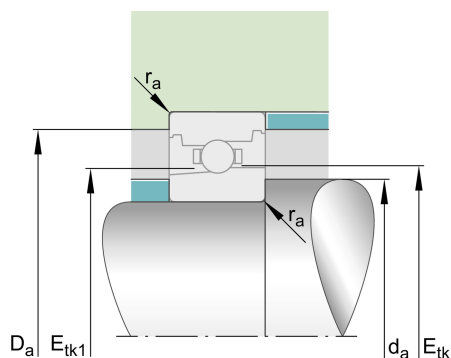
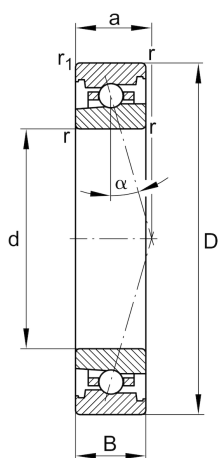
**Temperature range**

T_{\min}	-30 °C	Operating temperature min.
T_{\max}	100 °C	Operating temperature max.
	0,249 kg	Weight

Main Dimensions & Performance Data

d	45 mm	Bore diameter
D	75 mm	Outside diameter
B	16 mm	Width
C_r	11.600 N	Basic dynamic load rating, radial
C_{0r}	7.100 N	Basic static load rating, radial
C_{ur}	750 N	Fatigue load limit, radial
$n_{G \text{ Grease}}$	24.000 1/min	Limiting speed for grease lubrication
$n_{G \text{ Oil}}$	36.000 1/min	Limiting speed for oil lubrication

Dimensions

r_{\min}	1 mm	Minimum chamfer dimension
$r_{1 \min}$	1 mm	Minimum chamfer dimension
α	25 °	Contact angle

