

FAG

HS7015-E-T-P4S-UL

Angular contact ball bearing

Schaeffler ID:
0191842710000Spindle bearings HS70..-E, adjusted,
in pairs or sets, contact angle $\alpha = 25^\circ$,
restricted tolerances

Technical information

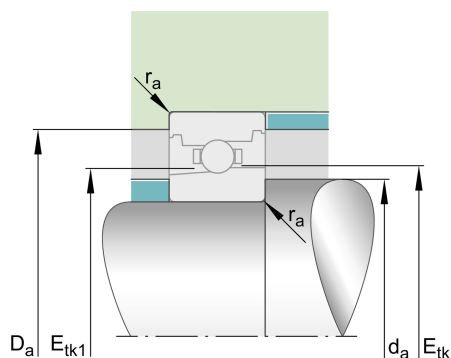
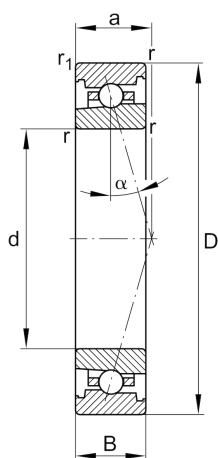
**Temperature range**

T_{min}	-30 °C	Operating temperature min.
T_{max}	100 °C	Operating temperature max.
	0,658 kg	Weight

Main Dimensions & Performance Data

d	75 mm	Bore diameter
D	115 mm	Outside diameter
B	20 mm	Width
C_r	23.900 N	Basic dynamic load rating, radial
C_{0r}	17.000 N	Basic static load rating, radial
C_{ur}	1.800 N	Fatigue load limit, radial
$n_{G Grease}$	15.000 1/min	Limiting speed for grease lubrication
$n_{G Oil}$	24.000 1/min	Limiting speed for oil lubrication

Dimensions

r_{min}	1,1 mm	Minimum chamfer dimension
$r_{1 min}$	1,1 mm	Minimum chamfer dimension
α	25 °	Contact angle

Mounting dimensions

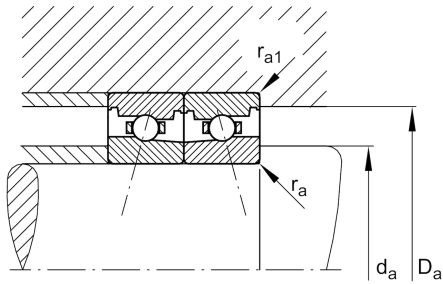

d_a	82 mm	Diameter shaft shoulder
d_a	h12	Diameter shaft shoulder clearance
D_a	107 mm	Shoulder diameter outer ring
D_a	H12	Shoulder diameter outer ring clearance
$r_{a \max}$	1 mm	Maximum recess radius
$r_{a1 \max}$	0,6 mm	Maximum recess radius
$E_{tk \min}$	90,2 mm	Minimum diameter injection pitch
$E_{tk \max}$	92,4 mm	Maximum diameter injection pitch
$E_{tk1 \min}$	87,3 mm	Minimum diameter injection pitch
$E_{tk1 \max}$	92,4 mm	Maximum diameter injection pitch
a	32,1 mm	Distance between the apexes of the pressure cones

Additional information

F_{VL}	144 N	Preload force light
F_{VM}	431 N	Preload force medium
F_{VH}	863 N	Preload force heavy
K_{aEL}	415 N	Lift-off force light
K_{aEM}	1.268 N	Lift-off force medium
K_{aEH}	2.587 N	Lift-off force heavy
c_{aL}	135 N/ μ m	Axial rigidity light
c_{aM}	200 N/ μ m	Axial rigidity medium
c_{aH}	261 N/ μ m	Axial rigidity heavy