

FAG

HS7019-E-T-P4S-UL

Angular contact ball bearing

Schaeffler ID:
0191843950000Spindle bearings HS70..-E, adjusted,
in pairs or sets, contact angle $\alpha = 25^\circ$,
restricted tolerances

Technical information

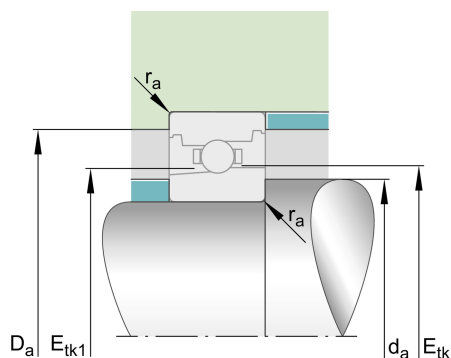
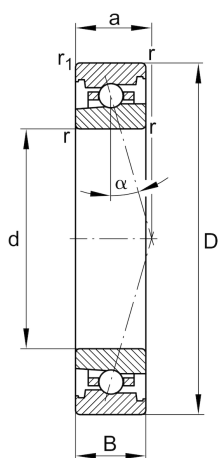
**Temperature range**

T_{\min}	-30 °C	Operating temperature min.
T_{\max}	100 °C	Operating temperature max.
	1,25 kg	Weight

Main Dimensions & Performance Data

d	95 mm	Bore diameter
D	145 mm	Outside diameter
B	24 mm	Width
C_r	34.000 N	Basic dynamic load rating, radial
C_{0r}	26.000 N	Basic static load rating, radial
C_{ur}	2.500 N	Fatigue load limit, radial
$n_{G \text{ Grease}}$	12.000 1/min	Limiting speed for grease lubrication
$n_{G \text{ Oil}}$	18.000 1/min	Limiting speed for oil lubrication

Dimensions

r_{\min}	1,5 mm	Minimum chamfer dimension
$r_{1 \min}$	1,5 mm	Minimum chamfer dimension
α	25 °	Contact angle

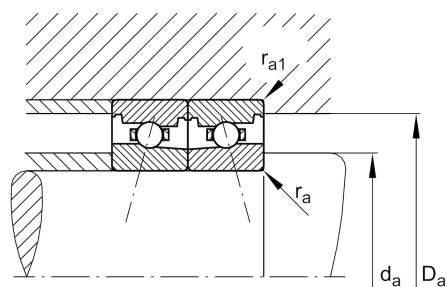

Mounting dimensions

d_a	105 mm	Diameter shaft shoulder
d_a	h12	Diameter shaft shoulder clearance
D_a	136 mm	Shoulder diameter outer ring
D_a	H12	Shoulder diameter outer ring clearance
$r_{a \max}$	1,5 mm	Maximum recess radius
$r_{a1 \max}$	0,6 mm	Maximum recess radius
$E_{tk \min}$	114,3 mm	Minimum diameter injection pitch
$E_{tk \max}$	116,8 mm	Maximum diameter injection pitch
$E_{tk1 \min}$	110,7 mm	Minimum diameter injection pitch
$E_{tk1 \max}$	116,8 mm	Maximum diameter injection pitch
a	40 mm	Distance between the apexes of the pressure cones

Additional information

F_{VL}	204 N	Preload force light
F_{VM}	612 N	Preload force medium
F_{VH}	1.225 N	Preload force heavy
K_{aEL}	588 N	Lift-off force light
K_{aEM}	1.797 N	Lift-off force medium
K_{aEH}	3.663 N	Lift-off force heavy
c_{aL}	168 N/ μ m	Axial rigidity light
c_{aM}	249 N/ μ m	Axial rigidity medium
c_{aH}	324 N/ μ m	Axial rigidity heavy