

FAG

★ HS7020-E-T-P4S-UL

Angular contact ball bearing

Schaeffler ID:
0191844330000

★ Preferred product

Spindle bearings HS70...-E, adjusted,
in pairs or sets, contact angle $\alpha = 25^\circ$,
restricted tolerances

Technical information

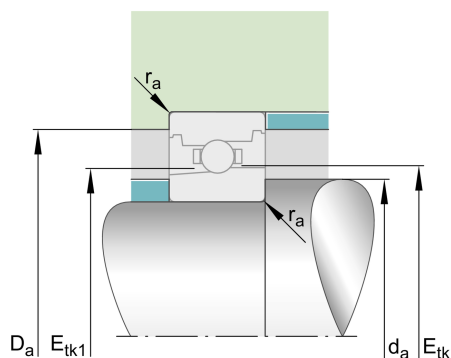
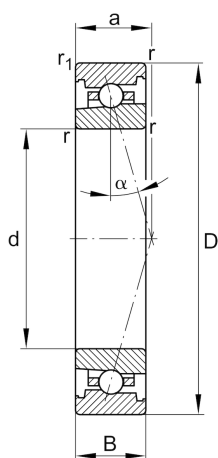

Temperature range

T_{\min}	-30 °C	Operating temperature min.
T_{\max}	100 °C	Operating temperature max.
	1,299 kg	Weight

Main Dimensions & Performance Data

d	100 mm	Bore diameter
D	150 mm	Outside diameter
B	24 mm	Width
C_r	34.500 N	Basic dynamic load rating, radial
C_{0r}	27.000 N	Basic static load rating, radial
C_{ur}	2.550 N	Fatigue load limit, radial
$n_{G \text{ Grease}}$	11.000 1/min	Limiting speed for grease lubrication
$n_{G \text{ Oil}}$	17.000 1/min	Limiting speed for oil lubrication

Dimensions

r_{\min}	1,5 mm	Minimum chamfer dimension
$r_{1 \min}$	1,5 mm	Minimum chamfer dimension
α	25 °	Contact angle

