

FAG

HS7021-E-T-P4S-UL

Angular contact ball bearing

Schaeffler ID:
0387258600000Spindle bearings HS70..-E, adjusted,
in pairs or sets, contact angle $\alpha = 25^\circ$,
restricted tolerances

Technical information

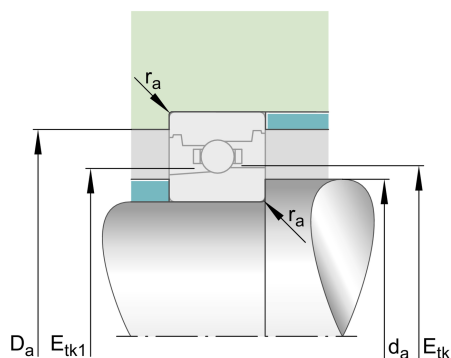
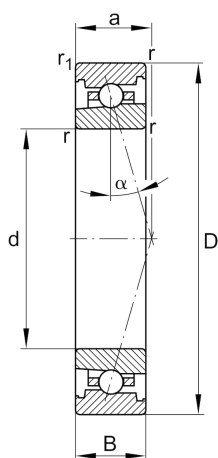
**Temperature range**

| | | |
|------------|----------|----------------------------|
| T_{\min} | -30 °C | Operating temperature min. |
| T_{\max} | 100 °C | Operating temperature max. |
| | 1,628 kg | Weight |

Main Dimensions & Performance Data

| | | |
|------------------------|--------------|---------------------------------------|
| d | 105 mm | Bore diameter |
| D | 160 mm | Outside diameter |
| B | 26 mm | Width |
| C_r | 45.000 N | Basic dynamic load rating, radial |
| C_{0r} | 34.500 N | Basic static load rating, radial |
| C_{ur} | 3.150 N | Fatigue load limit, radial |
| $n_{G \text{ Grease}}$ | 11.000 1/min | Limiting speed for grease lubrication |
| $n_{G \text{ Oil}}$ | 16.000 1/min | Limiting speed for oil lubrication |

Dimensions

| | | |
|--------------|------|---------------------------|
| r_{\min} | 2 mm | Minimum chamfer dimension |
| $r_{1 \min}$ | 2 mm | Minimum chamfer dimension |
| α | 25 ° | Contact angle |

Mounting dimensions

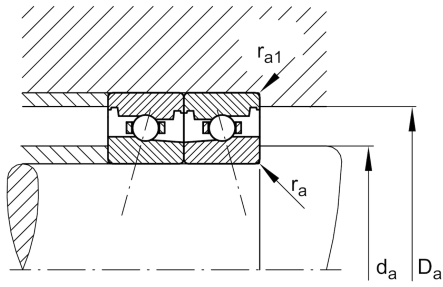

| | | |
|----------------|----------|---|
| d_a | 116 mm | Diameter shaft shoulder |
| d_a | h12 | Diameter shaft shoulder clearance |
| D_a | 150 mm | Shoulder diameter outer ring |
| D_a | H12 | Shoulder diameter outer ring clearance |
| $r_{a \max}$ | 2 mm | Maximum recess radius |
| $r_{a1 \max}$ | 1 mm | Maximum recess radius |
| $E_{tk \min}$ | 125,8 mm | Minimum diameter injection pitch |
| $E_{tk \max}$ | 129 mm | Maximum diameter injection pitch |
| $E_{tk1 \min}$ | 121,7 mm | Minimum diameter injection pitch |
| $E_{tk1 \max}$ | 129 mm | Maximum diameter injection pitch |
| a | 43,9 mm | Distance between the apexes of the pressure cones |

Additional information

| | | |
|-----------|----------------|-----------------------|
| F_{VL} | 267 N | Preload force light |
| F_{VM} | 802 N | Preload force medium |
| F_{VH} | 1.604 N | Preload force heavy |
| K_{aEL} | 770 N | Lift-off force light |
| K_{aEM} | 2.354 N | Lift-off force medium |
| K_{aEH} | 4.797 N | Lift-off force heavy |
| c_{aL} | 189 N/ μ m | Axial rigidity light |
| c_{aM} | 281 N/ μ m | Axial rigidity medium |
| c_{aH} | 365 N/ μ m | Axial rigidity heavy |