

FAG

**HS7024-E-T-P4S-UL**

Angular contact ball bearing

Schaeffler ID:  
0385488520000Spindle bearings HS70..-E, adjusted,  
in pairs or sets, contact angle  $\alpha = 25^\circ$ ,  
restricted tolerances

## Technical information

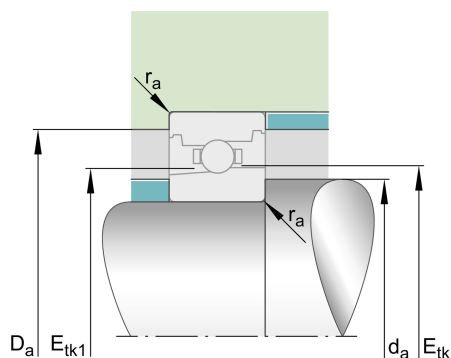
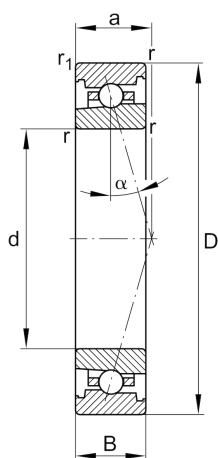
**Temperature range**

$T_{\min}$	-30 °C	Operating temperature min.
$T_{\max}$	100 °C	Operating temperature max.
	2,22 kg	Weight

**Main Dimensions & Performance Data**

d	120 mm	Bore diameter
D	180 mm	Outside diameter
B	28 mm	Width
$C_r$	46.500 N	Basic dynamic load rating, radial
$C_{0r}$	38.500 N	Basic static load rating, radial
$C_{ur}$	3.300 N	Fatigue load limit, radial
$n_{G \text{ Grease}}$	9.500 1/min	Limiting speed for grease lubrication
$n_{G \text{ Oil}}$	14.000 1/min	Limiting speed for oil lubrication

**Dimensions**

$r_{\min}$	2 mm	Minimum chamfer dimension
$r_{1 \min}$	2 mm	Minimum chamfer dimension
$\alpha$	25 °	Contact angle

### Mounting dimensions

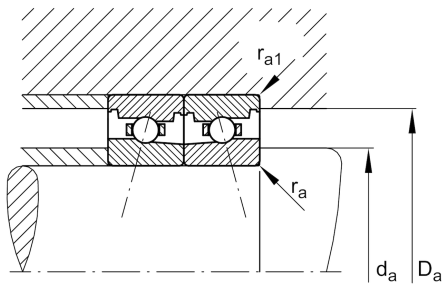

$d_a$	131 mm	Diameter shaft shoulder
$d_a$	h12	Diameter shaft shoulder clearance
$D_a$	169 mm	Shoulder diameter outer ring
$D_a$	H12	Shoulder diameter outer ring clearance
$r_{a \max}$	2 mm	Maximum recess radius
$r_{a1 \max}$	1 mm	Maximum recess radius
$E_{tk \min}$	143,3 mm	Minimum diameter injection pitch
$E_{tk \max}$	146,4 mm	Maximum diameter injection pitch
$E_{tk1 \min}$	139,2 mm	Minimum diameter injection pitch
$E_{tk1 \max}$	146,4 mm	Maximum diameter injection pitch
$a$	49 mm	Distance between the apexes of the pressure cones

### Additional information

$F_{VL}$	276 N	Preload force light
$F_{VM}$	828 N	Preload force medium
$F_{VH}$	1.656 N	Preload force heavy
$K_{aEL}$	795 N	Lift-off force light
$K_{aEM}$	2.426 N	Lift-off force medium
$K_{aEH}$	4.942 N	Lift-off force heavy
$c_{aL}$	203 N/ $\mu\text{m}$	Axial rigidity light
$c_{aM}$	302 N/ $\mu\text{m}$	Axial rigidity medium
$c_{aH}$	392 N/ $\mu\text{m}$	Axial rigidity heavy