

FAG

HS7026-E-T-P4S-UL

Angular contact ball bearing

Schaeffler ID:
0384691200000Spindle bearings HS70..-E, adjusted,
in pairs or sets, contact angle $\alpha = 25^\circ$,
restricted tolerances

Technical information

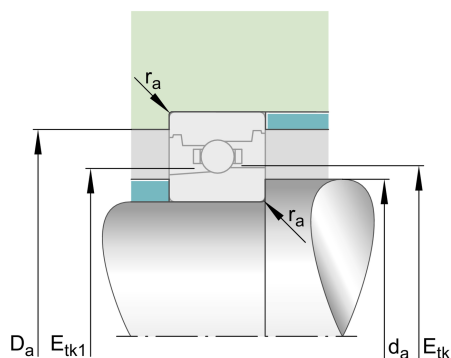
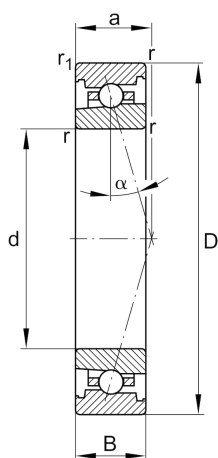
**Temperature range**

T_{\min}	-30 °C	Operating temperature min.
T_{\max}	100 °C	Operating temperature max.
	3,43 kg	Weight

Main Dimensions & Performance Data

d	130 mm	Bore diameter
D	200 mm	Outside diameter
B	33 mm	Width
C_r	60.000 N	Basic dynamic load rating, radial
C_{0r}	50.000 N	Basic static load rating, radial
C_{ur}	4.150 N	Fatigue load limit, radial
$n_{G \text{ Grease}}$	8.500 1/min	Limiting speed for grease lubrication
$n_{G \text{ Oil}}$	13.000 1/min	Limiting speed for oil lubrication

Dimensions

r_{\min}	2 mm	Minimum chamfer dimension
$r_{1 \min}$	2 mm	Minimum chamfer dimension
α	25 °	Contact angle

Mounting dimensions

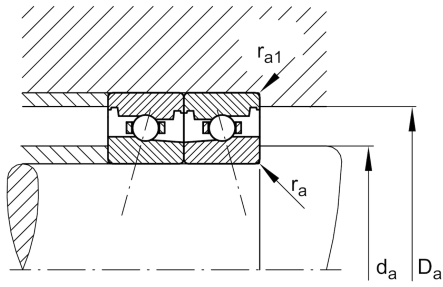

d_a	142 mm	Diameter shaft shoulder
d_a	h12	Diameter shaft shoulder clearance
D_a	189 mm	Shoulder diameter outer ring
D_a	H12	Shoulder diameter outer ring clearance
$r_{a \max}$	2 mm	Maximum recess radius
$r_{a1 \max}$	1 mm	Maximum recess radius
$E_{tk \min}$	157,4 mm	Minimum diameter injection pitch
$E_{tk \max}$	161,2 mm	Maximum diameter injection pitch
$E_{tk1 \min}$	152,6 mm	Minimum diameter injection pitch
$E_{tk1 \max}$	161,2 mm	Maximum diameter injection pitch
a	55 mm	Distance between the apexes of the pressure cones

Additional information

F_{VL}	357 N	Preload force light
F_{VM}	1.070 N	Preload force medium
F_{VH}	2.139 N	Preload force heavy
K_{aEL}	1.026 N	Lift-off force light
K_{aEM}	3.133 N	Lift-off force medium
K_{aEH}	6.381 N	Lift-off force heavy
c_{aL}	231 N/ μm	Axial rigidity light
c_{aM}	344 N/ μm	Axial rigidity medium
c_{aH}	446 N/ μm	Axial rigidity heavy