

FAG

★ 20206-TVP

Barrel roller bearing

Schaeffler ID:
0167017470000Barrel roller bearings 202, main
dimensions to DIN 635-1

★ Preferred product

Technical information

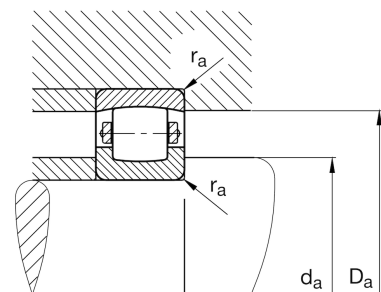
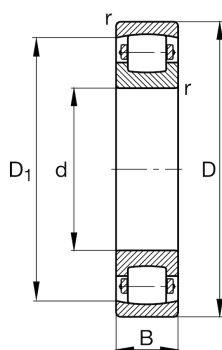

Temperature range

T_{\min}	-30 °C	Operating temperature min.
T_{\max}	120 °C	Operating temperature max.
	0,204 kg	Weight

Main Dimensions & Performance Data

d	30 mm	Bore diameter
D	62 mm	Outside diameter
B	16 mm	Width
C_r	28.000 N	Basic dynamic load rating, radial
C_{0r}	28.500 N	Basic static load rating, radial
C_{ur}	2.950 N	Fatigue load limit, radial
n_G	10.800 1/min	Limiting speed

Dimensions

r_{\min}	1 mm	Minimum chamfer dimension
D_1	53 mm	Bore diameter outer ring

Mounting dimensions

$d_{a \min}$	35,6 mm	Minimum diameter shaft shoulder
$D_{a \max}$	56,4 mm	Maximum diameter of housing shoulder
$r_{a \max}$	1 mm	Maximum recess radius