

FAG

## ★ 20210-TVP

Barrel roller bearing

Schaeffler ID:  
0167018010000Barrel roller bearings 202, main  
dimensions to DIN 635-1

★ Preferred product

## Technical information

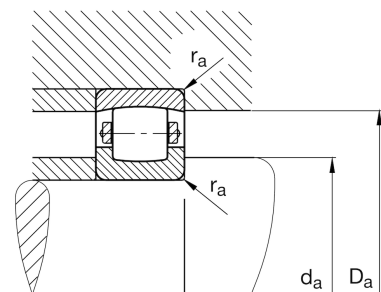
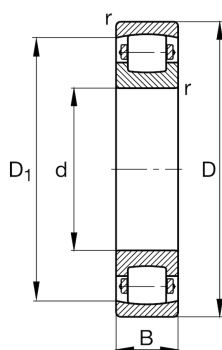

## Temperature range

$T_{\min}$	-30 °C	Operating temperature min.
$T_{\max}$	120 °C	Operating temperature max.
	0,481 kg	Weight

## Main Dimensions &amp; Performance Data

d	50 mm	Bore diameter
D	90 mm	Outside diameter
B	20 mm	Width
$C_r$	59.000 N	Basic dynamic load rating, radial
$C_{0r}$	69.000 N	Basic static load rating, radial
$C_{ur}$	7.200 N	Fatigue load limit, radial
$n_G$	7.700 1/min	Limiting speed

## Dimensions

$r_{\min}$	1,1 mm	Minimum chamfer dimension
$D_1$	79,5 mm	Bore diameter outer ring

## Mounting dimensions

$d_{a \min}$	57 mm	Minimum diameter shaft shoulder
$D_{a \max}$	83 mm	Maximum diameter of housing shoulder
$r_{a \max}$	1 mm	Maximum recess radius