

FAG★ **20224-MB**

Barrel roller bearing

Schaeffler ID:
0167020340000

Barrel roller bearing 202...-MB

★ Preferred product

Technical information

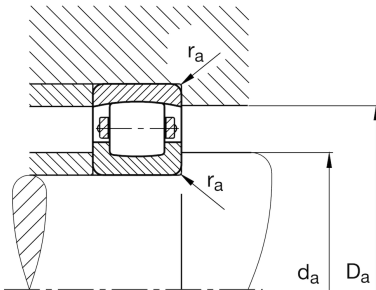
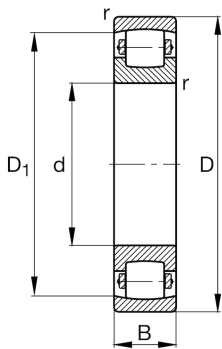

Temperature range

T_{\min}	-30 °C	Operating temperature min.
T_{\max}	200 °C	Operating temperature max.
	6,678 kg	Weight

Main Dimensions & Performance Data

d	120 mm	Bore diameter
D	215 mm	Outside diameter
B	40 mm	Width
C_r	305.000 N	Basic dynamic load rating, radial
C_{0r}	415.000 N	Basic static load rating, radial
C_{ur}	38.500 N	Fatigue load limit, radial
n_G	3.350 1/min	Limiting speed

Dimensions

r_{\min}	2,1 mm	Minimum chamfer dimension
D_1	191,1 mm	Bore diameter outer ring

Mounting dimensions

$d_{a \min}$	132 mm	Minimum diameter shaft shoulder
$D_{a \max}$	203 mm	Maximum diameter of housing shoulder
$r_{a \max}$	2,1 mm	Maximum recess radius