

FAG

## ★ 20310-TVP

Barrel roller bearing

Schaeffler ID:  
0190140900000Barrel roller bearings 203, main  
dimensions to DIN 635-1

★ Preferred product

## Technical information

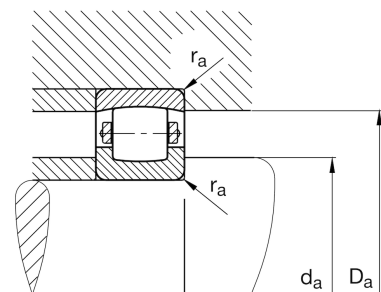
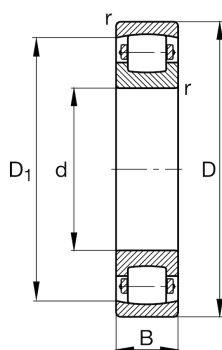

## Temperature range

$T_{\min}$	-30 °C	Operating temperature min.
$T_{\max}$	120 °C	Operating temperature max.
	1,138 kg	Weight

## Main Dimensions &amp; Performance Data

d	50 mm	Bore diameter
D	110 mm	Outside diameter
B	27 mm	Width
$C_r$	108.000 N	Basic dynamic load rating, radial
$C_{0r}$	118.000 N	Basic static load rating, radial
$C_{ur}$	10.600 N	Fatigue load limit, radial
$n_G$	5.800 1/min	Limiting speed

## Dimensions

$r_{\min}$	2 mm	Minimum chamfer dimension
$D_1$	94,4 mm	Bore diameter outer ring

## Mounting dimensions

$d_{a \min}$	61 mm	Minimum diameter shaft shoulder
$D_{a \max}$	99 mm	Maximum diameter of housing shoulder
$r_{a \max}$	2 mm	Maximum recess radius