

FAG

20320-MB

Barrel roller bearing

Schaeffler ID:
0167021740000Barrel roller bearings 203, main
dimensions to DIN 635-1

Technical information

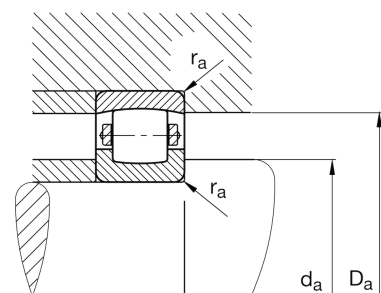
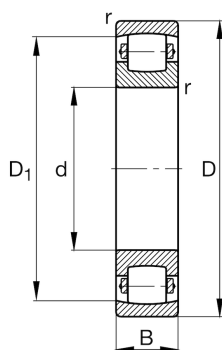
**Temperature range**

T_{\min}	-30 °C	Operating temperature min.
T_{\max}	200 °C	Operating temperature max.
	8,62 kg	Weight

Main Dimensions & Performance Data

d	100 mm	Bore diameter
D	215 mm	Outside diameter
B	47 mm	Width
C_r	365.000 N	Basic dynamic load rating, radial
C_{0r}	440.000 N	Basic static load rating, radial
C_{ur}	38.500 N	Fatigue load limit, radial
n_G	3.250 1/min	Limiting speed

Dimensions

r_{\min}	3 mm	Minimum chamfer dimension
D_1	186,6 mm	Bore diameter outer ring

Mounting dimensions

$d_{a \min}$	114 mm	Minimum diameter shaft shoulder
$D_{a \max}$	201 mm	Maximum diameter of housing shoulder
$r_{a \max}$	2,5 mm	Maximum recess radius