



FAG

## ★ NJ238-E-M1

Cylindrical roller bearing

Schaeffler ID:  
0167359780000

★ Preferred product

Cylindrical roller bearing NJ..-E-M1, with cage, single row, semi-locating bearing, 2 ribs on outer ring, 1 rib on inner ring, type NJ

## Technical information

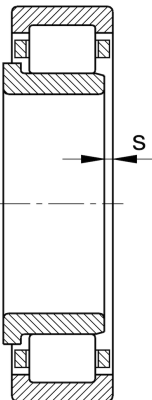
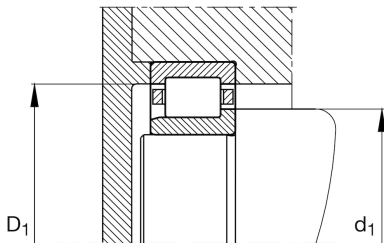
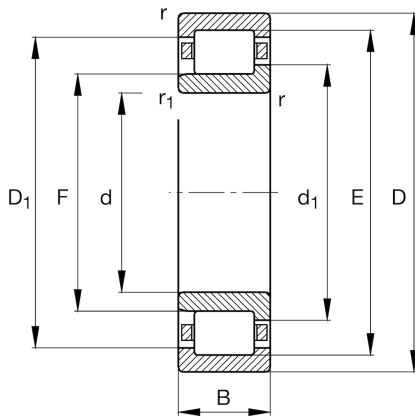

## Temperature range

$T_{min}$	-30 °C	Operating temperature min.
$T_{max}$	150 °C	Operating temperature max.
	22,42 kg	Weight

## Main Dimensions &amp; Performance Data

d	190 mm	Bore diameter
D	340 mm	Outside diameter
B	55 mm	Width
$C_r$	680.000 N	Basic dynamic load rating, radial
$C_{0r}$	930.000 N	Basic static load rating, radial
$C_{ur}$	113.000 N	Fatigue load limit, radial
$n_G$	3.050 1/min	Limiting speed
$n_{gr}$	1.720 1/min	Reference speed

## Dimensions

$r_{min}$	4 mm	Minimum chamfer dimension
$r_{1min}$	4 mm	Minimum chamfer dimension
s	4,7 mm	Axial displacement
E	306 mm	Raceway diameter outer ring
F	230 mm	Raceway diameter inner ring
$D_{1min}$	295 mm	Minimum rib diameter outer ring
$d_1$	244 mm	Maximum rib diameter inner ring

## Mounting dimensions

$d_{amin}$	207 mm	Minimum diameter shaft shoulder
$d_{amax}$	227 mm	Maximum diameter of shaft shoulder
$D_{amax}$	323 mm	Maximum diameter of housing shoulder
$d_{cmin}$	247 mm	Minimum shaft shoulder
$r_{amax}$	3 mm	Maximum recess radius

## Additional information

HJ238-E

L-washer

