

FAG

## ★ NJ244-E-M1

Cylindrical roller bearing

Schaeffler ID:  
0192274340000

★ Preferred product

Cylindrical roller bearing NJ..-E-M1, with cage, single row, semi-locating bearing, 2 ribs on outer ring, 1 rib on inner ring, type NJ

## Technical information

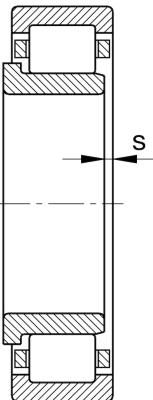
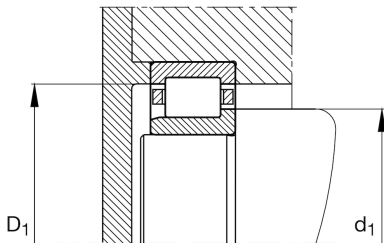
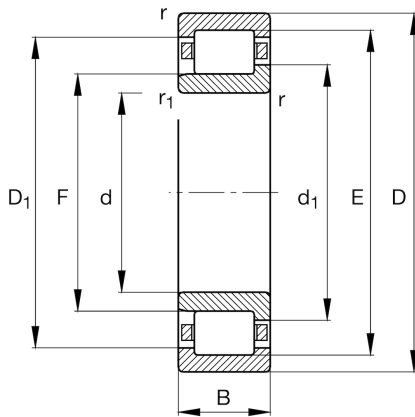

## Temperature range

$T_{\min}$	-30 °C	Operating temperature min.
$T_{\max}$	150 °C	Operating temperature max.
	37,64 kg	Weight

## Main Dimensions &amp; Performance Data

d	220 mm	Bore diameter
D	400 mm	Outside diameter
B	65 mm	Width
$C_r$	950.000 N	Basic dynamic load rating, radial
$C_{0r}$	1.330.000 N	Basic static load rating, radial
$C_{ur}$	152.000 N	Fatigue load limit, radial
$n_G$	2.600 1/min	Limiting speed
$n_{gr}$	1.380 1/min	Reference speed

## Dimensions

$r_{\min}$	4 mm	Minimum chamfer dimension
$r_{1\min}$	4 mm	Minimum chamfer dimension
s	5,5 mm	Axial displacement
E	358 mm	Raceway diameter outer ring
F	268 mm	Raceway diameter inner ring
$D_{1\min}$	344,9 mm	Minimum rib diameter outer ring
$d_1$	285,2 mm	Maximum rib diameter inner ring

## Mounting dimensions

$d_{a\min}$	237 mm	Minimum diameter shaft shoulder
$d_{a\max}$	265 mm	Maximum diameter of shaft shoulder
$D_{a\max}$	383 mm	Maximum diameter of housing shoulder
$d_{c\min}$	288 mm	Minimum shaft shoulder
$r_{a\max}$	3 mm	Maximum recess radius

## Additional information

HJ244-E

L-washer

