

FAG

**NJ332-E-M1**

Cylindrical roller bearing

Schaeffler ID:  
0190079060000

Cylindrical roller bearing NJ..-E-M1, with cage, single row, semi-locating bearing, 2 ribs on outer ring, 1 rib on inner ring, type NJ

## Technical information

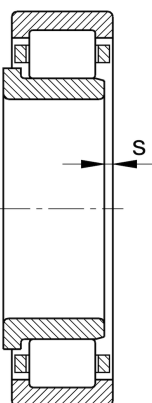
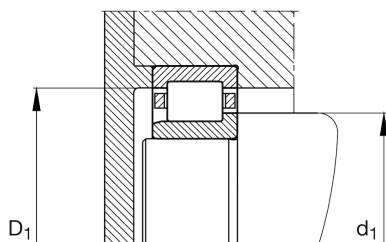
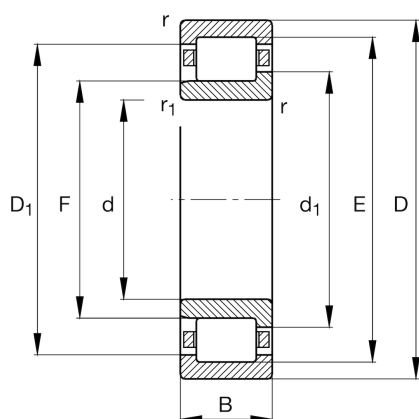

## Temperature range

$T_{\min}$	-30 °C	Operating temperature min.
$T_{\max}$	150 °C	Operating temperature max.
	31,44 kg	Weight

## Main Dimensions &amp; Performance Data

d	160 mm	Bore diameter
D	340 mm	Outside diameter
B	68 mm	Width
$C_r$	860.000 N	Basic dynamic load rating, radial
$C_{0r}$	1.060.000 N	Basic static load rating, radial
$C_{ur}$	130.000 N	Fatigue load limit, radial
$n_G$	3.000 1/min	Limiting speed
$n_{gr}$	1.770 1/min	Reference speed

## Dimensions

$r_{\min}$	4 mm	Minimum chamfer dimension
$r_{1\min}$	4 mm	Minimum chamfer dimension
s	5,6 mm	Axial displacement
E	300 mm	Raceway diameter outer ring
F	204 mm	Raceway diameter inner ring
$D_{1\min}$	286 mm	Minimum rib diameter outer ring
$d_1$	221,6 mm	Maximum rib diameter inner ring

## Mounting dimensions

$d_{a\min}$	177 mm	Minimum diameter shaft shoulder
$d_{a\max}$	200 mm	Maximum diameter of shaft shoulder
$D_{a\max}$	323 mm	Maximum diameter of housing shoulder
$d_{c\min}$	228 mm	Minimum shaft shoulder
$r_{a\max}$	3 mm	Maximum recess radius

## Additional information

HJ332-E

L-washer

