

FAG

★ 23128-E1A-XL-K-M

Spherical roller bearing

Schaeffler ID:
0190311650000

★ Preferred product

Spherical roller bearings 231...E1A-K, main dimensions to DIN 635-2, with tapered bore, taper 1:12

X-life

Technical information

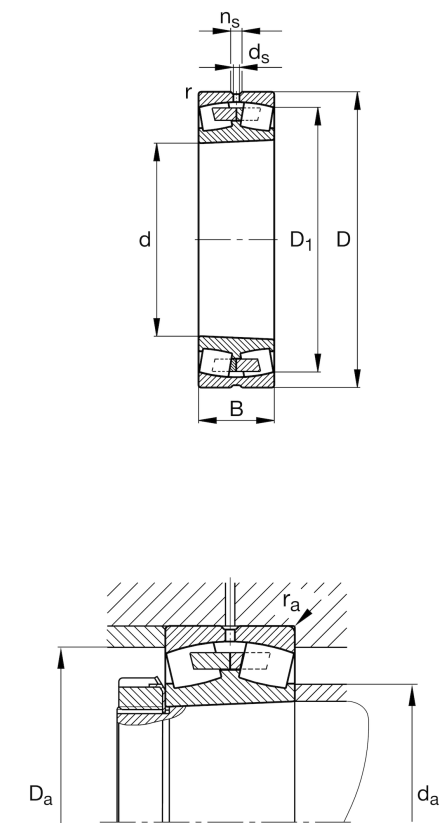

Temperature range

T _{min}	-30 °C	Operating temperature min.
T _{max}	200 °C	Operating temperature max.
	9,915 kg	Weight

Main Dimensions & Performance Data

d	140 mm	Bore diameter
D	225 mm	Outside diameter
B	68 mm	Width
C _r	760.000 N	Basic dynamic load rating, radial
C _{0r}	1.010.000 N	Basic static load rating, radial
C _{ur}	90.000 N	Fatigue load limit, radial
n _G	3.000 1/min	Limiting speed
n _{gr}	1.930 1/min	Reference speed

Dimensions

r _{min}	2,1 mm	Minimum chamfer dimension
D ₁	201 mm	Bore diameter outer ring
d _s	4,8 mm	Diameter lubrication hole
n _s	9,5 mm	Width of lubricating groove

Mounting dimensions

d _{a min}	152 mm	Minimum diameter shaft shoulder
D _{a max}	213 mm	Maximum diameter of housing shoulder
r _{a max}	2,1 mm	Maximum recess radius
d _{a max}	159 mm	Maximum diameter of shaft shoulder
d _{b min}	149 mm	Minimum cavity diameter of the sleeve
B _{a min}	8 mm	Minimum cavity width of the sleeve

Additional information		
e	0,27	Limiting value of Fa/Fr for the applicability of diff. Values of factors X and Y
	H3128	Adapter sleeve
Y ₁	2,49	Dynamic axial load factor
	AHX3128	Withdrawal sleeve
Y ₂	3,71	Dynamic axial load factor
Y ₀	2,43	Static axial load factor