

Technical information

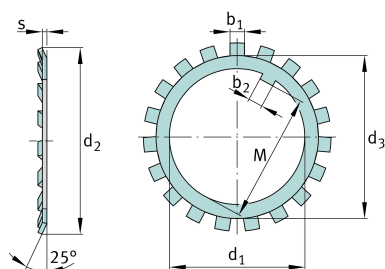

Main Dimensions & Performance Data

d_1	150 mm	bore diameter
d_2	205 mm	Outside diameter
s	2 mm	Thickness
	0,001 kg	Weight

Dimensions

	100	Counted quantity
--	-----	------------------

Mounting dimensions

d_3	171 mm	Plant diameter outside
b_2	16 mm	Distance lug
M	145 mm	Distance lug
b_1	14 mm	Width lock washer tab