

**FAG****KM5**

Locknut

Schaeffler ID:  
0380409990000

Locknuts KM, main dimensions to DIN 981

## Technical information

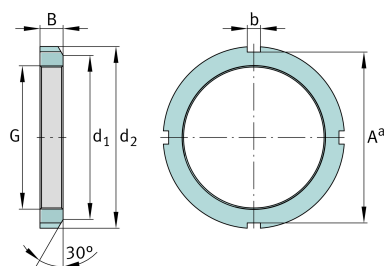
**Main Dimensions & Performance Data**

G	M25x1,5	Thread
d <sub>2</sub>	38 mm	Outerside diameter
B	7 mm	Width
	34 g	Weight

**Additional information**

F	24.000 N	Axial load capacity, static
	MB5	Fuse
	30 °	Chamfer angle

**Mounting dimensions**

d <sub>1</sub>	32 mm	Chamfer diameter
b	5 mm	Width retaining slot
A <sup>a</sup>	34 mm	Groove base distance