

KML28

Locknut

Schaeffler ID:  
0192026950000

Locknuts KML, main dimensions to DIN  
981

Technical information

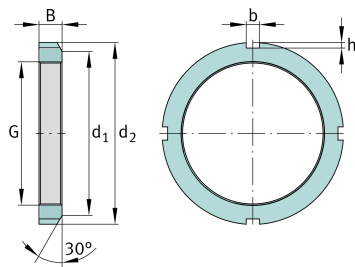

Main Dimensions & Performance Data

G	M140x2	Thread
d 2	165 mm	Outerside diameter
B	22 mm	Width
	1,04 kg	Weight

Additional information

F	410.000 N	Axial load capacity, static
	MBL28	Fuse
	30 °	Chamfer angle

Mounting dimensions

d 1	155 mm	Chamfer diameter
b	12 mm	Width retaining slot
h	5 mm	Hight retaining slot