

FAG

KML34

Locknut

Schaeffler ID:
0192027170000

Locknuts KML, main dimensions to DIN
981

Technical information

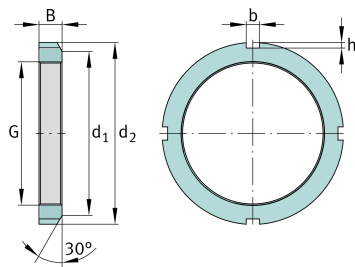

Main Dimensions & Performance Data

G	M170x3	Thread
d 2	200 mm	Outerside diameter
B	26 mm	Width
	1,817 kg	Weight

Additional information

F	560.000 N	Axial load capacity, static
	MBL34	Fuse
	30 °	Chamfer angle

Mounting dimensions

d 1	190 mm	Chamfer diameter
b	16 mm	Width retaining slot
h	5 mm	Hight retaining slot