

FAG

KML36

Locknut

Schaeffler ID:
0192027250000

Locknuts KML, main dimensions to DIN
981

Technical information

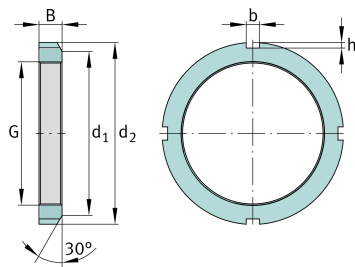

Main Dimensions & Performance Data

G	M180x3	Thread
d 2	210 mm	Outerside diameter
B	27 mm	Width
	2,03 kg	Weight

Additional information

F	610.000 N	Axial load capacity, static
	MBL36	Fuse
	30 °	Chamfer angle

Mounting dimensions

d 1	200 mm	Chamfer diameter
b	16 mm	Width retaining slot
h	5 mm	Hight retaining slot