

BK2520

Drawn cup needle roller bearing closed end

Schaeffler ID:
0001771050000

Drawn cup needle roller bearings with
closed end BK, to DIN 618/ISO 3245

Technical information

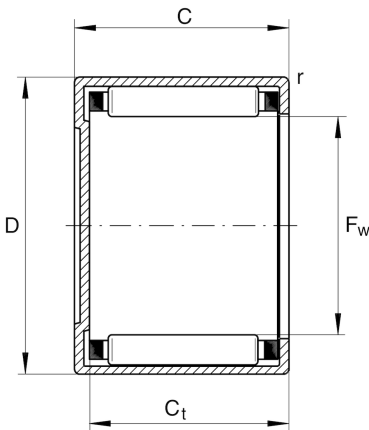

Main Dimensions & Performance Data

F _w	25 mm	Under roller diameter
D	32 mm	Outside diameter
C	20 mm	Width, outer ring
C _r	19.900 N	Basic dynamic load rating, radial
C _{0r}	33.000 N	Basic static load rating, radial
C _{ur}	4.300 N	Fatigue load limit, radial
n _G	10.200 1/min	Limiting speed
n _{G Grease}	6.100 1/min	Limiting speed for grease lubrication
n _{gr}	7.400 1/min	Reference speed
	38 g	Weight

Additional information

r _{min}	0,8 mm	Minimum chamfer dimension
	SD25X32X4	Sealing ring
C _{t min}	17,3 mm	Minimum width to base of drawn cup with closed end
	G25X32X4	Sealing ring 2
	LR20X25X20,5	Suitable inner rings LR
	IR20X25X20-XL	Suitable inner rings IR

Temperature range

T _{min}	-30 °C	Operating temperature min.
T _{max}	140 °C	Operating temperature max.