



IMAGE  
COMING SOON



## GRA012-NPP-B-AS2/V

Radial insert ball bearing

Schaeffler ID:  
0502871090000

Radial insert ball bearing GRA...NPP-B-  
AS2/V

### Technical information

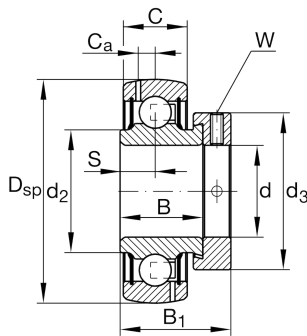

#### Main Dimensions & Performance Data

d	19,05 mm	Bore diameter
d	0.75 inch	Bore diameter, inch
D <sub>SP</sub>	47 mm	Outside diameter
B <sub>1</sub>	31 mm	Locking collar total width
B	21,4 mm	Width
C <sub>ur</sub>	345 N	Fatigue load limit, radial
C <sub>r</sub>	13.600 N	Basic dynamic load rating, radial
C <sub>0r</sub>	6.600 N	Basic static load rating, radial
	0,002 kg	Weight

#### Dimensions

C	14 mm	Width, outer ring
S	7,5 mm	Distance raceway
d <sub>2</sub>	26,9 mm	Rib diameter sealing inner ring
C <sub>a</sub>	3,9 mm	Distance to lubrication hole
d <sub>3</sub>	33 mm	Outside diameter locking collar/locknut
W	0.125 inch	Width across flats (Inch)

#### Calculation factors

f <sub>0</sub>	13,1	Calculation factor
----------------	------	--------------------