

GE35-AX

Spherical plain bearing

Schaeffler ID:
0066542230000

Axial spherical plain bearing, requiring maintenance, sliding contact surface: steel/steel

Technical information

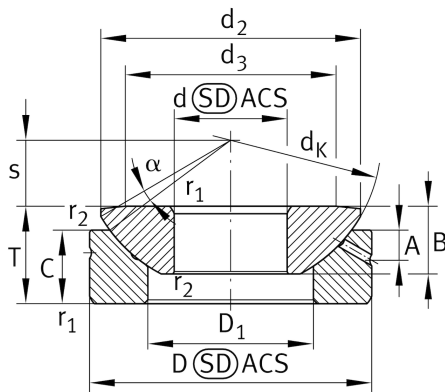

Main Dimensions & Performance Data

d	35 mm	Inner diameter bearing
D	90 mm	Outside diameter bearing
T	28 mm	Height
C _a	259.000 N	Basic dynamic load rating, axial
C _{0a}	1.300.000 N	Basic static load rating, axial
	1,023 kg	Weight

Dimensions

d _K	98 mm	Ball diameter
d ₂	84 mm	Connection measure Inner ring
d ₃	66 mm	Thread size
D ₁	52 mm	Inner diameter of housing washer
B	22 mm	Width
C	20 mm	Width Outer ring
s	22 mm	Plane Surface Spacing
A	8 mm	Distance lubrication Bore
α	6 °	Tilt angle
d _{OT}	0 mm	Bore diameter bearing, upper tolerance
d _{UT}	-0,012 mm	Lower tolerance, inner diameter bearing
D _{OT}	0 mm	Outer diameter, upper tolerance
D _{UT}	-0,015 mm	Outside diameter, lower tolerance
T _{OT}	0 mm	Height, upper tolerance
T _{UT}	-0,4 mm	Height, lower tolerance
C _{OT}	0 mm	Width outer ring, upper tolerance
C _{UT}	-0,24 mm	Width outer ring, lower tolerance
B _{OT}	0 mm	Width inner ring, upper tolerance
B _{UT}	-0,24 mm	Width inner ring, lower tolerance

Mounting dimensions

$r_{1\text{smin}}$	1 mm	Edge Spacing
$r_{2\text{smin}}$	0,3 mm	Edge Spacing
$d_{a\text{max}}$	66 mm	Connection measure Inner ring
$D_{a\text{min}}$	57 mm	Housing Connection Diameter

Temperature range

T_{min}	-60 °C	Operating temperature min.
T_{max}	200 °C	Operating temperature max.