



GLCTE20-TV-FA125.5

Flanged housing unit

Schaeffler ID:
0574652900000

Flanged housing unit GLCTE...-TV

Technical information

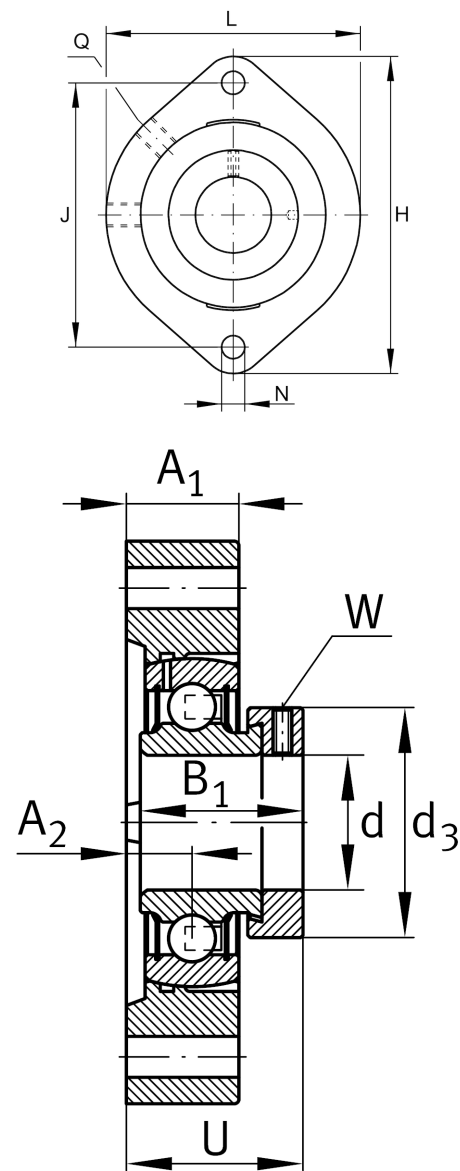

Main Dimensions & Performance Data

d	20 mm	Bore diameter
L	66,5 mm	Flange width
H	90,5 mm	Height flange
U	33,5 mm	Total height unit
C _r	13.600 N	Basic dynamic load rating, radial
C _{0r}	6.600 N	Basic static load rating, radial
C _{0rG}	7.200 N	Load carrying capacity (housing)
C _g	7.200 N	Load carrying capacity (housing)
	0,26 kg	Weight

Dimensions

	1	Number of housings
A ₁	18,4 mm	Thickness of flange
A ₂	9,5 mm	Distance raceway
	GEH.GLCTE04-TV	Housing
	GRAE20-NPP-B-FA107/125.5	Bearing designation
B ₁	31 mm	Locking collar total width
	KASK04-S-G	Protecting cap
Q	1/4-28 UNF	Connection thread lubrication
d ₃	33 mm	Outside diameter eccentric locking collar

Mounting dimensions

J	71,4 mm	Distance fixing bore
N	9 mm	Fixing bore
n	2	Number of screwing holes