



PCFTR17-XL

Flanged housing unit

Schaeffler ID:
0008317780000

Housing units PCFTR, three-bolt flanged housing units, cast iron, eccentric locking collar, P seals

X-life

Technical information

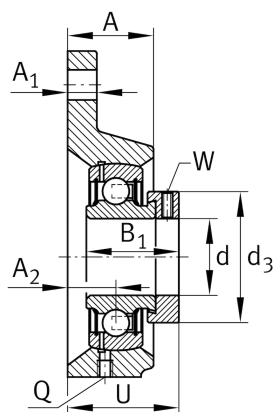
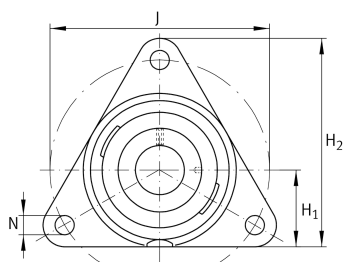

Main Dimensions & Performance Data

d	17 mm	Bore diameter
H ₂	81 mm	Height flange
U	32,1 mm	Total height unit
C _r	9.800 N	Basic dynamic load rating, radial
C _{0r}	4.750 N	Basic static load rating, radial
	0,43 kg	Weight

Dimensions

A	20 mm	Height housing
	1	Number of housings
A ₁	11 mm	Thickness of flange
A ₂	10 mm	Distance raceway
	CFTR03	Housing
H ₁	31 mm	Distance shaft axis
	GRAE17-XL-NPP-B	Bearing designation
Q	M6	Connection thread lubrication
d ₃	28,4 mm	Outside diameter eccentric locking collar

Mounting dimensions

J	76,1 mm	Pitch circle diameter (holes)
N	11.5 mm	Fixing bore
n	3	Number of screwing holes