

FAG

**6024-M**

Deep groove ball bearing

Schaeffler ID:  
0384044780000Deep groove ball bearing 60..-M, single  
row, solid brass cage

## Technical information

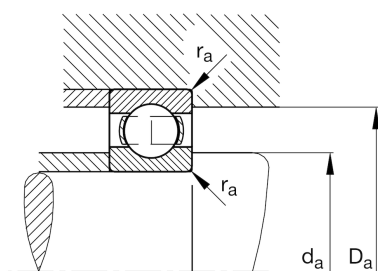
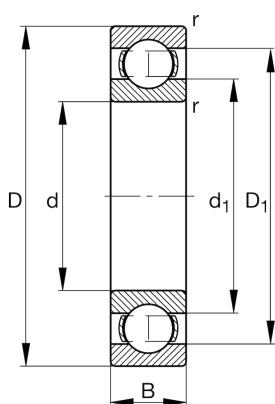
**Main Dimensions & Performance Data**

|          |             |                                   |
|----------|-------------|-----------------------------------|
| d        | 120 mm      | Bore diameter                     |
| D        | 180 mm      | Outside diameter                  |
| B        | 28 mm       | Width                             |
| $C_r$    | 88.000 N    | Basic dynamic load rating, radial |
| $C_{0r}$ | 77.000 N    | Basic static load rating, radial  |
| $C_{ur}$ | 3.650 N     | Fatigue load limit, radial        |
| $n_G$    | 6.500 1/min | Limiting speed                    |
| $n_{gr}$ | 4.450 1/min | Reference speed                   |
|          | 2,64 kg     | Weight                            |

**Dimensions**

|           |          |                              |
|-----------|----------|------------------------------|
| $r_{min}$ | 2 mm     | Minimum chamfer dimension    |
| $D_1$     | 161,2 mm | Shoulder diameter outer ring |
| $d_1$     | 139,4 mm | Shoulder diameter inner ring |

**Mounting dimensions**

|             |          |                                      |
|-------------|----------|--------------------------------------|
| $d_{a min}$ | 128,8 mm | Minimum diameter shaft shoulder      |
| $D_{a max}$ | 171,2 mm | Maximum diameter of housing shoulder |
| $r_{a max}$ | 2 mm     | Maximum fillet radius                |

**Calculation factors**

|       |      |                    |
|-------|------|--------------------|
| $f_0$ | 15,8 | Calculation factor |
|-------|------|--------------------|

**Temperature range**

|           |        |                            |
|-----------|--------|----------------------------|
| $T_{min}$ | -30 °C | Operating temperature min. |
| $T_{max}$ | 150 °C | Operating temperature max. |