

FAG

**6224-M**

Deep groove ball bearing

Schaeffler ID:  
0384051990000Deep groove ball bearing 62...-M, single  
row, solid brass cage

## Technical information

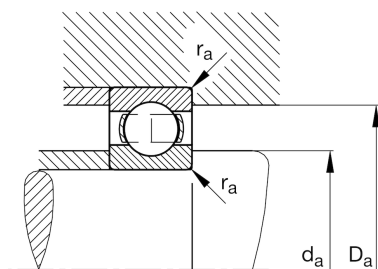
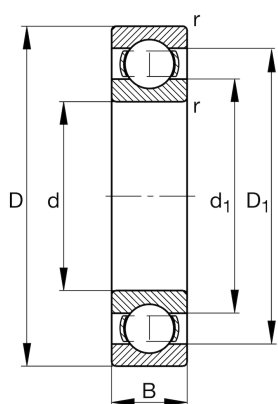
**Main Dimensions & Performance Data**

d	120 mm	Bore diameter
D	215 mm	Outside diameter
B	40 mm	Width
$C_r$	154.000 N	Basic dynamic load rating, radial
$C_{0r}$	123.000 N	Basic static load rating, radial
$C_{ur}$	6.400 N	Fatigue load limit, radial
$n_G$	5.500 1/min	Limiting speed
$n_{gr}$	4.250 1/min	Reference speed
	6,4 kg	Weight

**Dimensions**

$r_{min}$	2,1 mm	Minimum chamfer dimension
$D_1$	185,6 mm	Shoulder diameter outer ring
$d_1$	151,5 mm	Shoulder diameter inner ring

**Mounting dimensions**

$d_{a min}$	132 mm	Minimum diameter shaft shoulder
$D_{a max}$	203 mm	Maximum diameter of housing shoulder
$r_{a max}$	2,1 mm	Maximum fillet radius

**Calculation factors**

$f_0$	14,8	Calculation factor
-------	------	--------------------

**Temperature range**

$T_{min}$	-30 °C	Operating temperature min.
$T_{max}$	150 °C	Operating temperature max.