

KNO20-B-PP

Linear ball bearing

Schaeffler ID:
0193233870000

Linear ball bearings KNO..-B-PP,
Lightweight range, open design, sealed
on all sides, with relubrication facility,
adjustable angle

Technical information

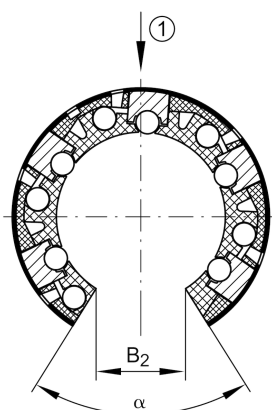
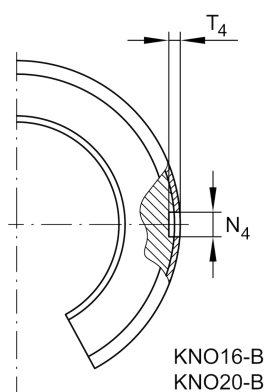

Main Dimensions & Performance Data

F_w	20 mm	Bore diameter of ball complement
D	32 mm	Outside diameter
L	45 mm	length
C_{max}	1.740 N	load capacity dyn.
C_{0max}	1.240 N	load capacity stat.
	50 g	Weight

Mounting dimensions

B_2	9 mm	Width of sector opening
T_4	0,9 mm	
N_4	3 mm	
α	55 °	Angle of sector opening
b_{1max}	2,5 mm	
	5	Number of rows balls

