



FAG

16021

Deep groove ball bearing

Schaeffler ID:
0167012320000Deep groove ball bearing 160, single row,
steel sheet metal cage

Technical information

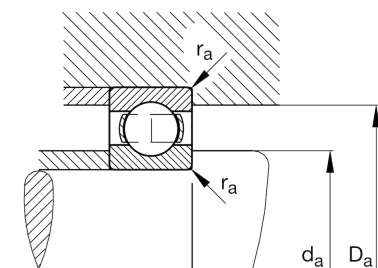
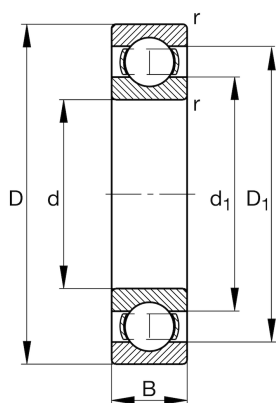
**Main Dimensions & Performance Data**

d	105 mm	Bore diameter
D	160 mm	Outside diameter
B	18 mm	Width
C_r	57.000 N	Basic dynamic load rating, radial
C_{0r}	54.000 N	Basic static load rating, radial
C_{ur}	2.460 N	Fatigue load limit, radial
n_G	5.900 1/min	Limiting speed
n_{gr}	3.950 1/min	Reference speed
	1,244 kg	Weight

Dimensions

r_{min}	1 mm	Minimum chamfer dimension
D_1	141,2 mm	Shoulder diameter outer ring
d_1	124,2 mm	Shoulder diameter inner ring

Mounting dimensions

$d_{a min}$	109,6 mm	Minimum diameter shaft shoulder
$D_{a max}$	155,4 mm	Maximum diameter of housing shoulder
$r_{a max}$	1 mm	Maximum fillet radius

Calculation factors

f_0	16,5	Calculation factor
-------	------	--------------------

Temperature range

T_{min}	-30 °C	Operating temperature min.
T_{max}	150 °C	Operating temperature max.