

E45-XL-KRR

Radial insert ball bearing

Schaeffler ID:
0008146010000

Radial insert ball bearings E..-KRR, cylindrical outer ring, location by eccentric locking collar, R seals on both sides

X-life

Technical information

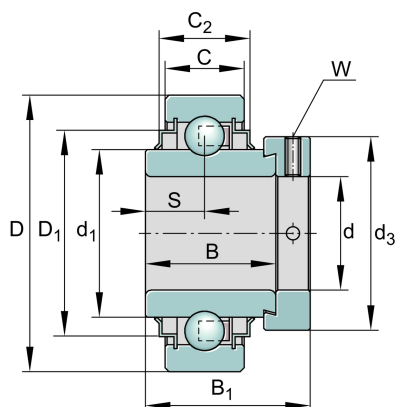

Main Dimensions & Performance Data

| | | |
|-----------------|----------|-----------------------------------|
| d | 45 mm | Bore diameter |
| D | 85 mm | Outside diameter |
| B | 42,9 mm | Width |
| B ₁ | 56,5 mm | Locking collar total width |
| C _r | 32.500 N | Basic dynamic load rating, radial |
| C _{0r} | 20.400 N | Basic static load rating, radial |
| C _{ur} | 970 N | Fatigue load limit, radial |
| | 0,85 kg | Weight |

Dimensions

| | | |
|----------------|---------|---|
| C | 22 mm | Width, outer ring |
| C ₂ | 26,4 mm | Sealing total width |
| S | 21,4 mm | Distance raceway |
| d ₁ | 57,9 mm | Rib diameter inner ring |
| D ₁ | 72,3 mm | Outside diameter seal |
| d ₃ | 63 mm | Outside diameter locking collar/locknut |
| W | 5 mm | Width of flats |

Calculation factors

| | | |
|----------------|------|--------------------|
| f ₀ | 14,1 | Calculation factor |
|----------------|------|--------------------|