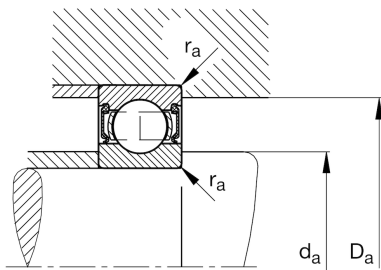
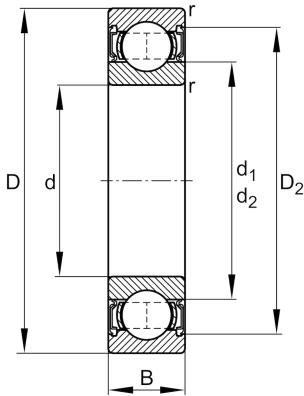
**FAG****6034-2RSR**

Deep groove ball bearing

Schaeffler ID:  
0676125550000Deep groove ball bearing 60..-2RSR,  
single row, seals, steel sheet metal cage

## Technical information

**Temperature range**

$T_{\min}$	-20 °C	Operating temperature min.
$T_{\max}$	110 °C	Operating temperature max.
	7,2 kg	Weight

**Main Dimensions & Performance Data**

d	170 mm	Bore diameter
D	260 mm	Outside diameter
B	42 mm	Width
$C_r$	179.000 N	Basic dynamic load rating, radial
$C_{0r}$	172.000 N	Basic static load rating, radial
$C_{ur}$	7.600 N	Fatigue load limit, radial
$n_G$	1.340 1/min	Limiting speed

**Dimensions**

$r_{\min}$	2,1 mm	Minimum chamfer dimension
$D_2$	236,5 mm	Caliber diameter outer ring
$d_1$	198,9 mm	Shoulder diameter inner ring

**Mounting dimensions**

$d_{a\min}$	180,2 mm	Minimum diameter shaft shoulder
$D_{a\max}$	249,8 mm	Maximum diameter of housing shoulder
$r_{a\max}$	2,1 mm	Maximum fillet radius

**Calculation factors**

$f_0$	15,7	Calculation factor
-------	------	--------------------