

FAG

★ 62300-A-2RSR

Deep groove ball bearing

Schaeffler ID:
0647760690000Deep groove ball bearing 623..-A-2RSR,
single row, steel sheet metal cage

★ Preferred product

Technical information

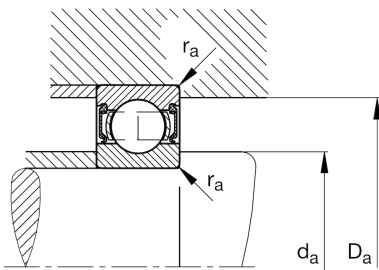
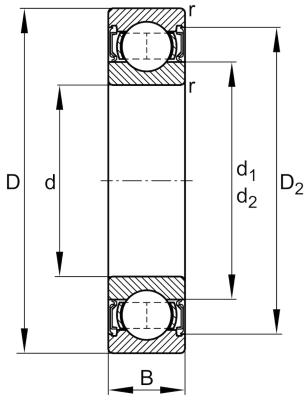

Temperature range

| | | |
|------------|--------|----------------------------|
| T_{\min} | -20 °C | Operating temperature min. |
| T_{\max} | 110 °C | Operating temperature max. |
| | 60 g | Weight |

Main Dimensions & Performance Data

| | | |
|----------|--------------|-----------------------------------|
| d | 10 mm | Bore diameter |
| D | 35 mm | Outside diameter |
| B | 17 mm | Width |
| C_r | 8.100 N | Basic dynamic load rating, radial |
| C_{0r} | 3.440 N | Basic static load rating, radial |
| C_{ur} | 270 N | Fatigue load limit, radial |
| n_G | 15.000 1/min | Limiting speed |

Dimensions

| | | |
|------------|---------|------------------------------|
| r_{\min} | 0,6 mm | Minimum chamfer dimension |
| D_2 | 29,5 mm | Caliber diameter outer ring |
| d_1 | 15,4 mm | Shoulder diameter inner ring |

Mounting dimensions

| | | |
|--------------|---------|--------------------------------------|
| $d_{a \min}$ | 14,2 mm | Minimum diameter shaft shoulder |
| $D_{a \max}$ | 30,8 mm | Maximum diameter of housing shoulder |
| $r_{a \max}$ | 0,6 mm | Maximum fillet radius |

Calculation factors

| | | |
|-------|------|--------------------|
| f_0 | 11,2 | Calculation factor |
|-------|------|--------------------|