



FAG

23188-BEA-XL-K-MB1

Spherical roller bearing

Schaeffler ID:  
0640874250000

Spherical roller bearing 231...-BEA-XL-K-MB1, symmetric 2 outer ribs with rib washer

X-life

Technical information

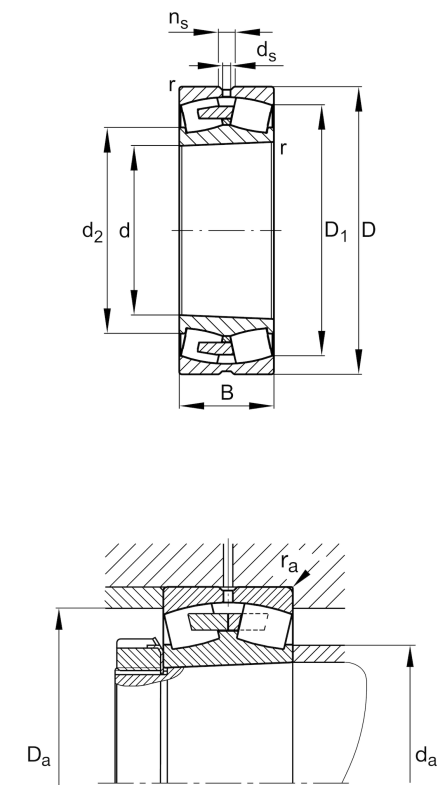

Temperature range

T <sub>min</sub>	-30 °C	Operating temperature min.
T <sub>max</sub>	200 °C	Operating temperature max.
	349,5 kg	Weight

Main Dimensions & Performance Data

d	440 mm	Bore diameter
D	720 mm	Outside diameter
B	226 mm	Width
C <sub>r</sub>	6.200.000 N	Basic dynamic load rating, radial
C <sub>0r</sub>	10.200.000 N	Basic static load rating, radial
C <sub>ur</sub>	700.000 N	Fatigue load limit, radial
n <sub>G</sub>	820 1/min	Limiting speed
n <sub>gr</sub>	430 1/min	Reference speed

Dimensions

r <sub>min</sub>	6 mm	Minimum chamfer dimension
D <sub>1</sub>	630,2 mm	Bore diameter outer ring
d <sub>s</sub>	12,5 mm	Diameter lubrication hole
n <sub>s</sub>	23,5 mm	Width of lubricating groove

Mounting dimensions

d <sub>a min</sub>	466 mm	Minimum diameter shaft shoulder
D <sub>a max</sub>	694 mm	Maximum diameter of housing shoulder
r <sub>a max</sub>	5 mm	Maximum recess radius
d <sub>a max</sub>	504 mm	Maximum diameter of shaft shoulder
d <sub>b min</sub>	463 mm	Minimum cavity diameter of the sleeve
B <sub>a min</sub>	17 mm	Minimum cavity width of the sleeve

Additional information		
e	0,3	Limiting value of Fa/Fr for the applicability of diff. Values of factors X and Y
	H3188-HG	Adapter sleeve
Y <sub>1</sub>	2,25	Dynamic axial load factor
	AHX3188G-H	Withdrawal sleeve
Y <sub>2</sub>	3,34	Dynamic axial load factor
Y <sub>0</sub>	2,2	Static axial load factor