

## Guideways LFS52-E (Series LFS..-E)

solid profile, with two raceway shafts; corrosion-resistant design possible

The datasheet is only an overview of dimensions and basic load ratings of the selected product. Please always observe all the guidelines in these overview pages. Further information is given on many products under the menu item "Description". You can also order comprehensive information via the Catalogue ordering system ([https://www.schaeffler.de/content.schaeffler.de/en/news\\_media/index.jsp](https://www.schaeffler.de/content.schaeffler.de/en/news_media/index.jsp)) or by telephone on +49 (91 32) 82 - 28 97.

h	34 mm	
b	52 mm	
l <sub>max</sub>	8000 mm	Maximum length L of guideway; longer guideways are supplied in several sections and are marked accordingly.
1)	Underside marked	
a <sub>2</sub>	42 mm	
a <sub>L max</sub>	110 mm	a <sub>L</sub> and a <sub>R</sub> are dependent on the guideway length L
a <sub>L min</sub>	17 mm	a <sub>L</sub> and a <sub>R</sub> are dependent on the guideway length L
a <sub>R max</sub>	110 mm	a <sub>L</sub> and a <sub>R</sub> are dependent on the guideway length L
a <sub>R min</sub>	17 mm	a <sub>L</sub> and a <sub>R</sub> are dependent on the guideway length L
b <sub>1</sub>	40 mm	
d <sub>LW</sub>	10 mm	
e <sub>z</sub>	17,8 mm	

h <sub>1</sub>	21 mm	
h <sub>4</sub>	25,1 mm	
j <sub>L</sub>	125 mm	
LF <sub>Q</sub>	1170 mm <sup>2</sup>	Value for cross-sectional area
I <sub>y</sub>	138624 mm <sup>4</sup>	
I <sub>z</sub>	113037 mm <sup>4</sup>	
N <sub>1</sub>	11 mm	
N <sub>3</sub>	19 mm	For a maximum load F <sub>z</sub> or F <sub>oz</sub> , support washers to DIN 433 and the maximum tightening torque (see fitting instructions) must be used.
W <sub>y</sub>	5878 mm <sup>3</sup>	
W <sub>z</sub>	6350 mm <sup>3</sup>	
ms	4400 g/m	Mass of guideway
		Ordering designation: - Guideways in design with corrosion protection: LFS..-RB
		Modulus of elasticity for LFS..-C, -CE, -CEE, -E, -EE, -F, -FE: 72000 N/mm <sup>2</sup>

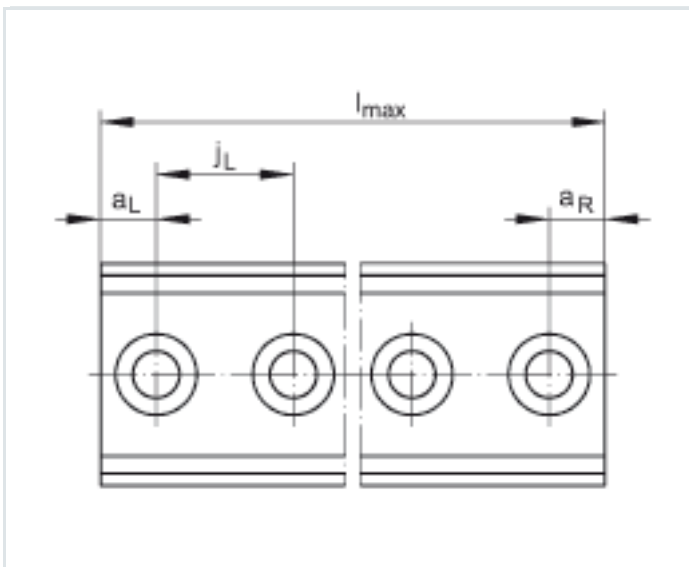
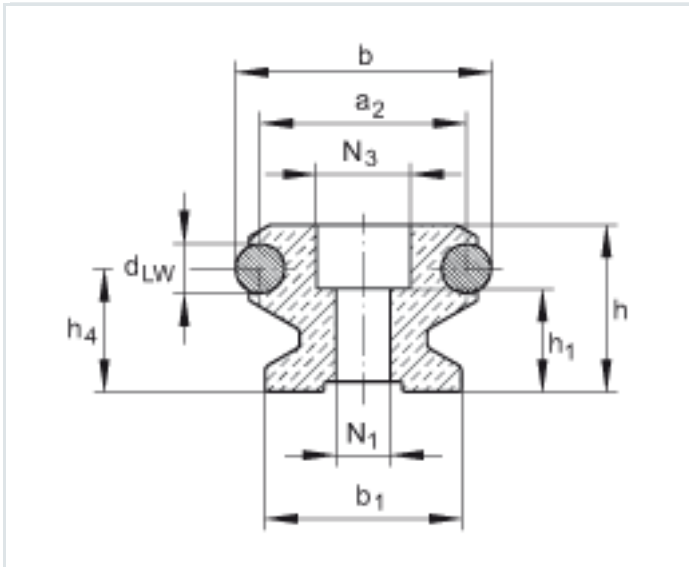

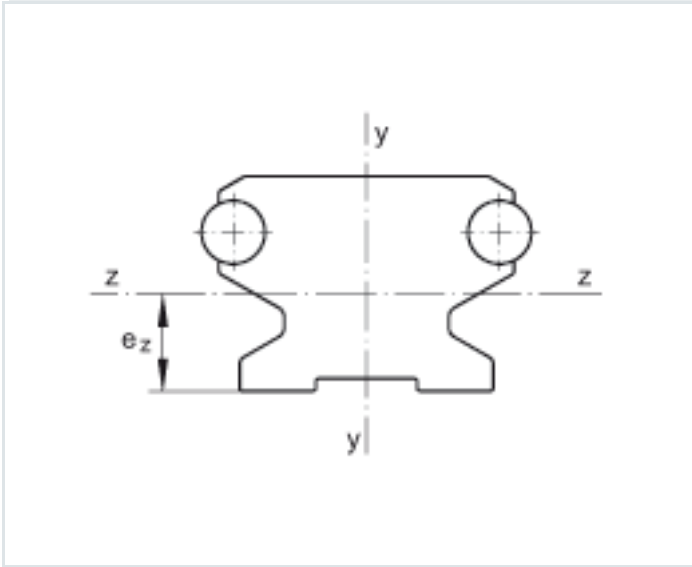

Bending axes