

FAG

## ★ 61812-2RSR-Y

Deep groove ball bearing

Schaeffler ID:  
0096194700000Deep groove ball bearing 618...-2RSR-Y,  
single row, seals, brass sheet metal cage

★ Preferred product

## Technical information

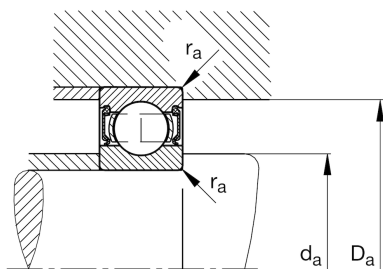
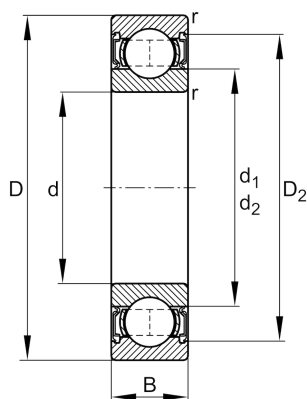

## Temperature range

$T_{\min}$	-20 °C	Operating temperature min.
$T_{\max}$	110 °C	Operating temperature max.
	0,105 kg	Weight

## Main Dimensions &amp; Performance Data

d	60 mm	Bore diameter
D	78 mm	Outside diameter
B	10 mm	Width
$C_r$	12.600 N	Basic dynamic load rating, radial
$C_{0r}$	11.100 N	Basic static load rating, radial
$C_{ur}$	710 N	Fatigue load limit, radial
$n_G$	4.100 1/min	Limiting speed

## Dimensions

$r_{\min}$	0,3 mm	Minimum chamfer dimension
$D_2$	74,5 mm	Caliber diameter outer ring
$d_1$	65,6 mm	Shoulder diameter inner ring

## Mounting dimensions

$d_{a \min}$	62 mm	Minimum diameter shaft shoulder
$D_{a \max}$	76 mm	Maximum diameter of housing shoulder
$r_{a \max}$	0,3 mm	Maximum fillet radius

## Calculation factors

$f_0$	16,3	Calculation factor
-------	------	--------------------