

FAG

★ 61816-2RSR-Y

Deep groove ball bearing

Schaeffler ID:
0096197120000Deep groove ball bearing 618..-2RSR-Y,
single row, seals, brass sheet metal cage

★ Preferred product

Technical information

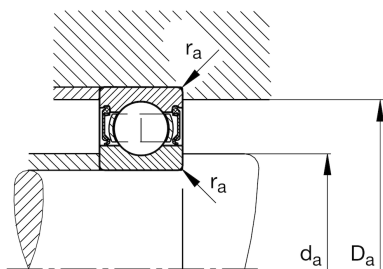
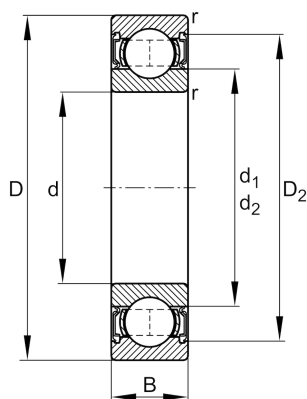

Temperature range

T_{\min}	-20 °C	Operating temperature min.
T_{\max}	110 °C	Operating temperature max.
	0,17 kg	Weight

Main Dimensions & Performance Data

d	80 mm	Bore diameter
D	100 mm	Outside diameter
B	10 mm	Width
C_r	13.800 N	Basic dynamic load rating, radial
C_{0r}	13.800 N	Basic static load rating, radial
C_{ur}	930 N	Fatigue load limit, radial
n_G	3.100 1/min	Limiting speed

Dimensions

r_{\min}	0,6 mm	Minimum chamfer dimension
D_2	95,5 mm	Caliber diameter outer ring
d_1	86,6 mm	Shoulder diameter inner ring

Mounting dimensions

$d_{a \min}$	83,2 mm	Minimum diameter shaft shoulder
$D_{a \max}$	96,8 mm	Maximum diameter of housing shoulder
$r_{a \max}$	0,6 mm	Maximum fillet radius

Calculation factors

f_0	16	Calculation factor
-------	----	--------------------