

FAG

★ 11210-TVH

Self-aligning ball bearing

Schaeffler ID:
0167001800000

Self-aligning ball bearing 112...-TVH, plastic cage

★ Preferred product

Technical information

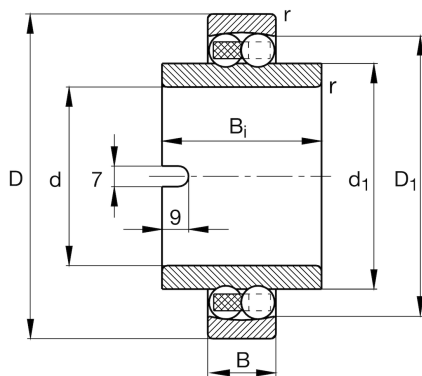
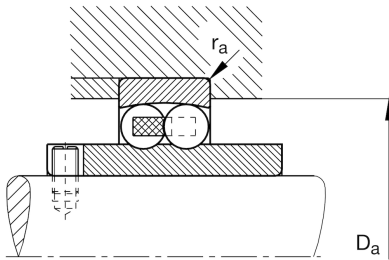

Main Dimensions & Performance Data

d	50 mm	Bore diameter
D	90 mm	Outside diameter
B	20 mm	Width, outer ring
B _i	58 mm	Width, inner ring
r _{min}	1,1 mm	Minimum chamfer dimension
C _r	22.900 N	Basic dynamic load rating, radial
C _{0r}	8.100 N	Basic static load rating, radial
C _{ur}	520 N	Fatigue load limit, radial
n _G	8.700 1/min	Limiting speed
n _{gr}	7.700 1/min	Reference speed
	0,85 kg	Weight

Dimensions

D ₁	77,1 mm	Shoulder diameter outer ring
d ₁	62,7 mm	Shoulder diameter inner ring
b	7 mm	Width retaining slot
t	9 mm	Height retaining slot

Mounting dimensions

D _{a max}	83 mm	Maximum diameter of housing shoulder
r _{a max}	1 mm	Maximaler Hohlkehlradius

Calculation factors

e	0,2	Limiting value of Fa/Fr for the applicability of diff. Values of factors X and Y
Y ₁	3,15	Dynamic axial load factor
Y ₂	4,87	Dynamic axial load factor
Y ₀	3,3	Static axial load factor