

FAG

★ 4211-B-TVH

Deep groove ball bearing

Schaeffler ID:
0167144070000Deep groove ball bearing 42...-B-TVH,
double row, plastic cage

★ Preferred product

Technical information

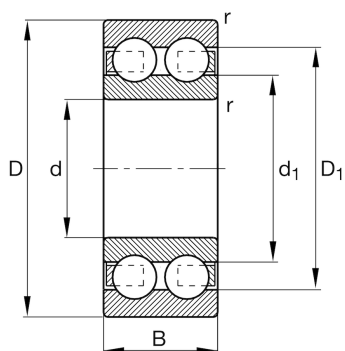

Temperature range

| | | |
|-----------|----------|----------------------------|
| T_{min} | -20 °C | Operating temperature min. |
| T_{max} | 120 °C | Operating temperature max. |
| | 0,813 kg | Weight |

Main Dimensions & Performance Data

| | | |
|----------|-------------|-----------------------------------|
| d | 55 mm | Bore diameter |
| D | 100 mm | Outside diameter |
| B | 25 mm | Width |
| C_r | 43.000 N | Basic dynamic load rating, radial |
| C_{0r} | 42.500 N | Basic static load rating, radial |
| C_{ur} | 2.200 N | Fatigue load limit, radial |
| n_G | 5.700 1/min | Limiting speed |
| n_{gr} | 5.900 1/min | Reference speed |

Dimensions

| | | |
|-----------|---------|------------------------------|
| r_{min} | 1,5 mm | Minimum chamfer dimension |
| D_1 | 84,7 mm | Shoulder diameter outer ring |
| d_1 | 71,4 mm | Shoulder diameter inner ring |

Mounting dimensions

| | | |
|-------------|--------|--------------------------------------|
| $d_{a min}$ | 64 mm | Minimum diameter shaft shoulder |
| $D_{a max}$ | 91 mm | Maximum diameter of housing shoulder |
| $r_{a max}$ | 1,5 mm | Maximum fillet radius |

Calculation factors

| | | |
|-------|------|--------------------|
| f_0 | 15,4 | Calculation factor |
|-------|------|--------------------|

