

FAG

★ 51109

Axial deep groove ball bearing

Schaeffler ID:
0167147170000Axial deep groove ball bearing 511, single
direction, steel sheet metal cage

★ Preferred product

Technical information

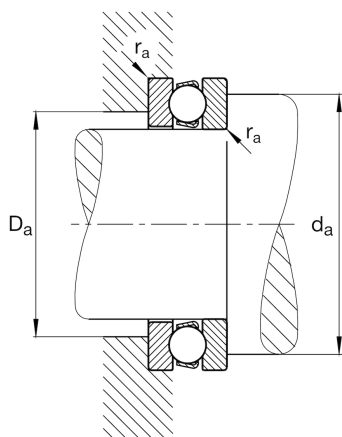
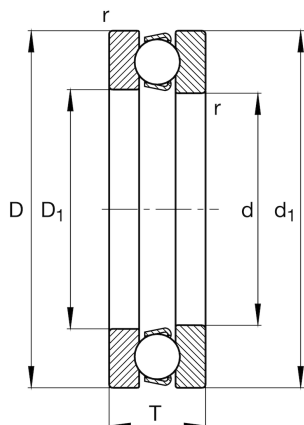

Temperature range

T_{\min}	-30 °C	Operating temperature min.
T_{\max}	150 °C	Operating temperature max.
	0,151 kg	Weight

Main Dimensions & Performance Data

d	45 mm	Bore diameter
D	65 mm	Outside diameter
T	14 mm	Height
C_a	26.500 N	Basic dynamic load rating, axial
C_{0a}	69.000 N	Basic static load rating, axial
C_{ua}	3.100 N	Fatigue load limit, axial
n_G	7.100 1/min	Limiting speed
n_{gr}	5.800 1/min	Reference speed

Dimensions

r_{\min}	0,6 mm	Minimum chamfer dimension
D_1	47 mm	Bore diameter housing washer
d_1	65 mm	Lip diameter shaft washer

Mounting dimensions

$d_{a\min}$	57 mm	Minimum diameter shaft shoulder
$D_{a\max}$	53 mm	Maximum diameter of housing shoulder
$r_{a\max}$	0,6 mm	Maximum recess radius

Additional information

A	0,025	Minimum load factor
---	-------	---------------------