

FAG

## ★ 6008

Deep groove ball bearing

Schaeffler ID:  
0167175110000Deep groove ball bearing 60, single row,  
steel sheet metal cage

★ Preferred product

## Technical information

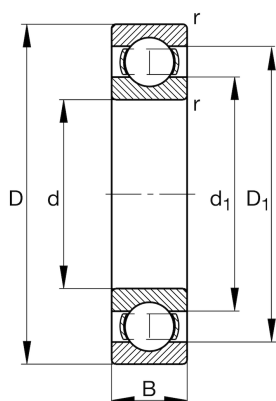

## Temperature range

|            |          |                            |
|------------|----------|----------------------------|
| $T_{\min}$ | -30 °C   | Operating temperature min. |
| $T_{\max}$ | 120 °C   | Operating temperature max. |
|            | 0,181 kg | Weight                     |

## Main Dimensions &amp; Performance Data

|          |              |                                   |
|----------|--------------|-----------------------------------|
| d        | 40 mm        | Bore diameter                     |
| D        | 68 mm        | Outside diameter                  |
| B        | 15 mm        | Width                             |
| $C_r$    | 17.800 N     | Basic dynamic load rating, radial |
| $C_{0r}$ | 11.500 N     | Basic static load rating, radial  |
| $C_{ur}$ | 600 N        | Fatigue load limit, radial        |
| $n_G$    | 14.600 1/min | Limiting speed                    |
| $n_{gr}$ | 10.600 1/min | Reference speed                   |

## Dimensions

|            |         |                              |
|------------|---------|------------------------------|
| $r_{\min}$ | 1 mm    | Minimum chamfer dimension    |
| $D_1$      | 59,1 mm | Shoulder diameter outer ring |
| $d_1$      | 49,3 mm | Shoulder diameter inner ring |

## Mounting dimensions

|             |         |                                      |
|-------------|---------|--------------------------------------|
| $d_{a\min}$ | 44,6 mm | Minimum diameter shaft shoulder      |
| $D_{a\max}$ | 63,4 mm | Maximum diameter of housing shoulder |
| $r_{a\max}$ | 1 mm    | Maximum fillet radius                |

## Calculation factors

|       |      |                    |
|-------|------|--------------------|
| $f_0$ | 15,2 | Calculation factor |
|-------|------|--------------------|