



FAG

★ 6022

Deep groove ball bearing

Schaeffler ID:
0167184450000Deep groove ball bearing 60, single row,
steel sheet metal cage

★ Preferred product

Technical information

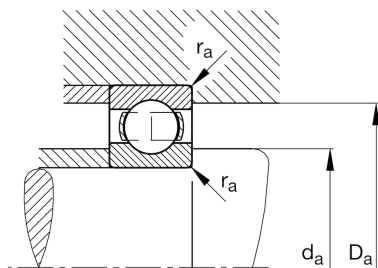
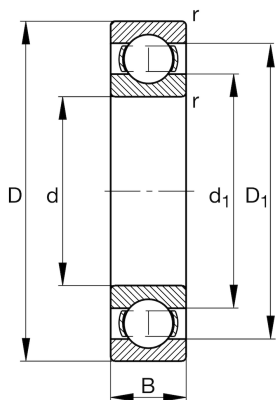

Temperature range

T_{\min}	-30 °C	Operating temperature min.
T_{\max}	150 °C	Operating temperature max.
	2,06 kg	Weight

Main Dimensions & Performance Data

d	110 mm	Bore diameter
D	170 mm	Outside diameter
B	28 mm	Width
C_r	85.000 N	Basic dynamic load rating, radial
C_{0r}	71.000 N	Basic static load rating, radial
C_{ur}	3.550 N	Fatigue load limit, radial
n_G	5.300 1/min	Limiting speed
n_{gr}	4.850 1/min	Reference speed

Dimensions

r_{\min}	2 mm	Minimum chamfer dimension
D_1	150,9 mm	Shoulder diameter outer ring
d_1	129,2 mm	Shoulder diameter inner ring

Mounting dimensions

$d_{a\min}$	118,8 mm	Minimum diameter shaft shoulder
$D_{a\max}$	161,2 mm	Maximum diameter of housing shoulder
$r_{a\max}$	2 mm	Maximum fillet radius

Calculation factors

f_0	15,7	Calculation factor
-------	------	--------------------