



FAG

★ 6210

Deep groove ball bearing

Schaeffler ID:
0167206520000Deep groove ball bearing 62, single row,
steel sheet metal cage

★ Preferred product

Technical information

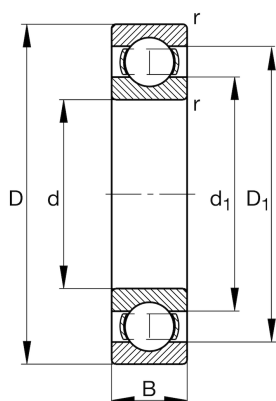

Temperature range

T_{\min}	-30 °C	Operating temperature min.
T_{\max}	120 °C	Operating temperature max.
	0,463 kg	Weight

Main Dimensions & Performance Data

d	50 mm	Bore diameter
D	90 mm	Outside diameter
B	20 mm	Width
C_r	39.000 N	Basic dynamic load rating, radial
C_{0r}	24.200 N	Basic static load rating, radial
C_{ur}	1.460 N	Fatigue load limit, radial
n_G	10.500 1/min	Limiting speed
n_{gr}	8.200 1/min	Reference speed

Dimensions

r_{\min}	1,1 mm	Minimum chamfer dimension
D_1	77,9 mm	Shoulder diameter outer ring
d_1	62 mm	Shoulder diameter inner ring

Mounting dimensions

$d_{a \min}$	57 mm	Minimum diameter shaft shoulder
$D_{a \max}$	83 mm	Maximum diameter of housing shoulder
$r_{a \max}$	1,1 mm	Maximum fillet radius

Calculation factors

f_0	14,3	Calculation factor
-------	------	--------------------