

FAG

## ★ 6211

## Deep groove ball bearing

Schaeffler ID:  
0167208060000Deep groove ball bearing 62, single row,  
steel sheet metal cage

★ Preferred product

## Technical information

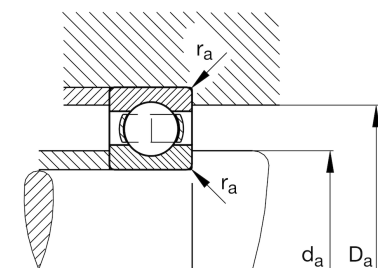
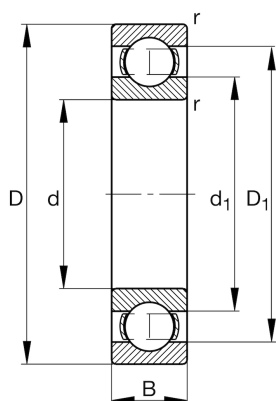

## Temperature range

$T_{\min}$	-30 °C	Operating temperature min.
$T_{\max}$	150 °C	Operating temperature max.
	0,594 kg	Weight

## Main Dimensions &amp; Performance Data

d	55 mm	Bore diameter
D	100 mm	Outside diameter
B	21 mm	Width
$C_r$	46.000 N	Basic dynamic load rating, radial
$C_{0r}$	29.000 N	Basic static load rating, radial
$C_{ur}$	1.770 N	Fatigue load limit, radial
$n_G$	9.500 1/min	Limiting speed
$n_{gr}$	7.500 1/min	Reference speed

## Dimensions

$r_{\min}$	1,5 mm	Minimum chamfer dimension
$D_1$	86,2 mm	Shoulder diameter outer ring
$d_1$	68,9 mm	Shoulder diameter inner ring

## Mounting dimensions

$d_{a\min}$	64 mm	Minimum diameter shaft shoulder
$D_{a\max}$	91 mm	Maximum diameter of housing shoulder
$r_{a\max}$	1,5 mm	Maximum fillet radius

## Calculation factors

$f_0$	14,2	Calculation factor
-------	------	--------------------