



FAG

## ★ 6217

## Deep groove ball bearing

Schaeffler ID:  
0167214380000Deep groove ball bearing 62, single row,  
steel sheet metal cage

★ Preferred product

## Technical information

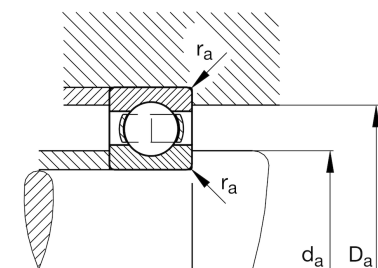
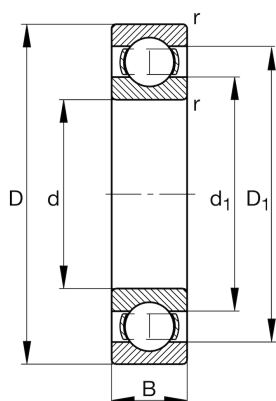

## Temperature range

$T_{\min}$	-30 °C	Operating temperature min.
$T_{\max}$	150 °C	Operating temperature max.
	1,798 kg	Weight

## Main Dimensions &amp; Performance Data

d	85 mm	Bore diameter
D	150 mm	Outside diameter
B	28 mm	Width
$C_r$	89.000 N	Basic dynamic load rating, radial
$C_{0r}$	64.000 N	Basic static load rating, radial
$C_{ur}$	4.050 N	Fatigue load limit, radial
$n_G$	6.700 1/min	Limiting speed
$n_{gr}$	5.300 1/min	Reference speed

## Dimensions

$r_{\min}$	2 mm	Minimum chamfer dimension
$D_1$	129,8 mm	Shoulder diameter outer ring
$d_1$	106,6 mm	Shoulder diameter inner ring

## Mounting dimensions

$d_{a \min}$	96 mm	Minimum diameter shaft shoulder
$D_{a \max}$	139 mm	Maximum diameter of housing shoulder
$r_{a \max}$	2 mm	Maximum fillet radius

## Calculation factors

$f_0$	14,8	Calculation factor
-------	------	--------------------