



FAG

## ★ 6220-2Z

Deep groove ball bearing

Schaeffler ID:  
0167216830000

Deep groove ball bearing 62...-2Z, single row, shields, steel sheet metal cage

★ Preferred product

## Technical information

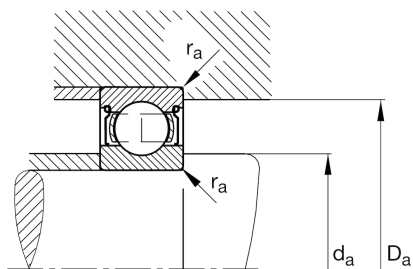
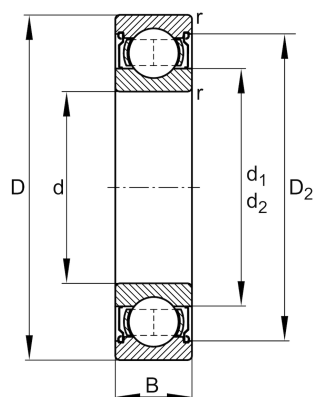

## Temperature range

$T_{\min}$	-20 °C	Operating temperature min.
$T_{\max}$	120 °C	Operating temperature max.
	3,36 kg	Weight

## Main Dimensions &amp; Performance Data

d	100 mm	Bore diameter
D	180 mm	Outside diameter
B	34 mm	Width
$C_r$	130.000 N	Basic dynamic load rating, radial
$C_{0r}$	93.000 N	Basic static load rating, radial
$C_{ur}$	5.500 N	Fatigue load limit, radial
$n_G$	4.250 1/min	Limiting speed
$n_{gr}$	4.800 1/min	Reference speed

## Dimensions

$r_{\min}$	2,1 mm	Minimum chamfer dimension
$D_2$	158,9 mm	Caliber diameter outer ring
$d_1$	124,7 mm	Shoulder diameter inner ring

## Mounting dimensions

$d_{a\min}$	112 mm	Minimum diameter shaft shoulder
$D_{a\max}$	168 mm	Maximum diameter of housing shoulder
$r_{a\max}$	2,1 mm	Maximum fillet radius

## Calculation factors

$f_0$	14,4	Calculation factor
-------	------	--------------------