



FAG

## ★ 6308

Deep groove ball bearing

Schaeffler ID:  
0167233760000Deep groove ball bearing 63, single row,  
steel sheet metal cage

★ Preferred product

## Technical information

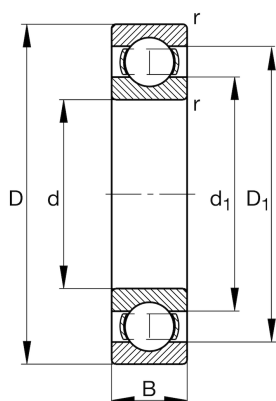

## Temperature range

$T_{\min}$	-30 °C	Operating temperature min.
$T_{\max}$	120 °C	Operating temperature max.
	0,611 kg	Weight

## Main Dimensions &amp; Performance Data

d	40 mm	Bore diameter
D	90 mm	Outside diameter
B	23 mm	Width
$C_r$	45.500 N	Basic dynamic load rating, radial
$C_{0r}$	25.000 N	Basic static load rating, radial
$C_{ur}$	1.690 N	Fatigue load limit, radial
$n_G$	10.800 1/min	Limiting speed
$n_{gr}$	9.000 1/min	Reference speed

## Dimensions

$r_{\min}$	1,5 mm	Minimum chamfer dimension
$D_1$	74,6 mm	Shoulder diameter outer ring
$d_1$	55,6 mm	Shoulder diameter inner ring

## Mounting dimensions

$d_{a\min}$	49 mm	Minimum diameter shaft shoulder
$D_{a\max}$	81 mm	Maximum diameter of housing shoulder
$r_{a\max}$	1,5 mm	Maximum fillet radius

## Calculation factors

$f_0$	13	Calculation factor
-------	----	--------------------