

FAG

★ 6315-M

Deep groove ball bearing

Schaeffler ID:
0191110530000Deep groove ball bearing 63..-M, single
row, solid brass cage

★ Preferred product

Technical information

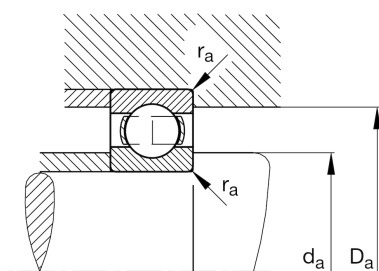
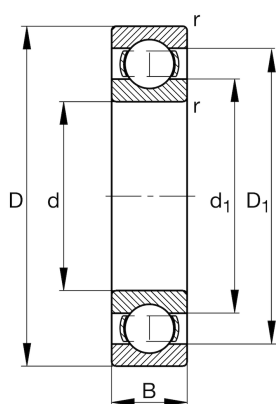

Temperature range

T_{\min}	-30 °C	Operating temperature min.
T_{\max}	150 °C	Operating temperature max.
	3,75 kg	Weight

Main Dimensions & Performance Data

d	75 mm	Bore diameter
D	160 mm	Outside diameter
B	37 mm	Width
C_r	123.000 N	Basic dynamic load rating, radial
C_{0r}	77.000 N	Basic static load rating, radial
C_{ur}	4.850 N	Fatigue load limit, radial
n_G	8.200 1/min	Limiting speed
n_{gr}	5.800 1/min	Reference speed

Dimensions

r_{\min}	2,1 mm	Minimum chamfer dimension
D_1	133,8 mm	Shoulder diameter outer ring
d_1	101,8 mm	Shoulder diameter inner ring

Mounting dimensions

$d_{a\min}$	87 mm	Minimum diameter shaft shoulder
$D_{a\max}$	148 mm	Maximum diameter of housing shoulder
$r_{a\max}$	2,1 mm	Maximum fillet radius

Calculation factors

f_0	13,2	Calculation factor
-------	------	--------------------